

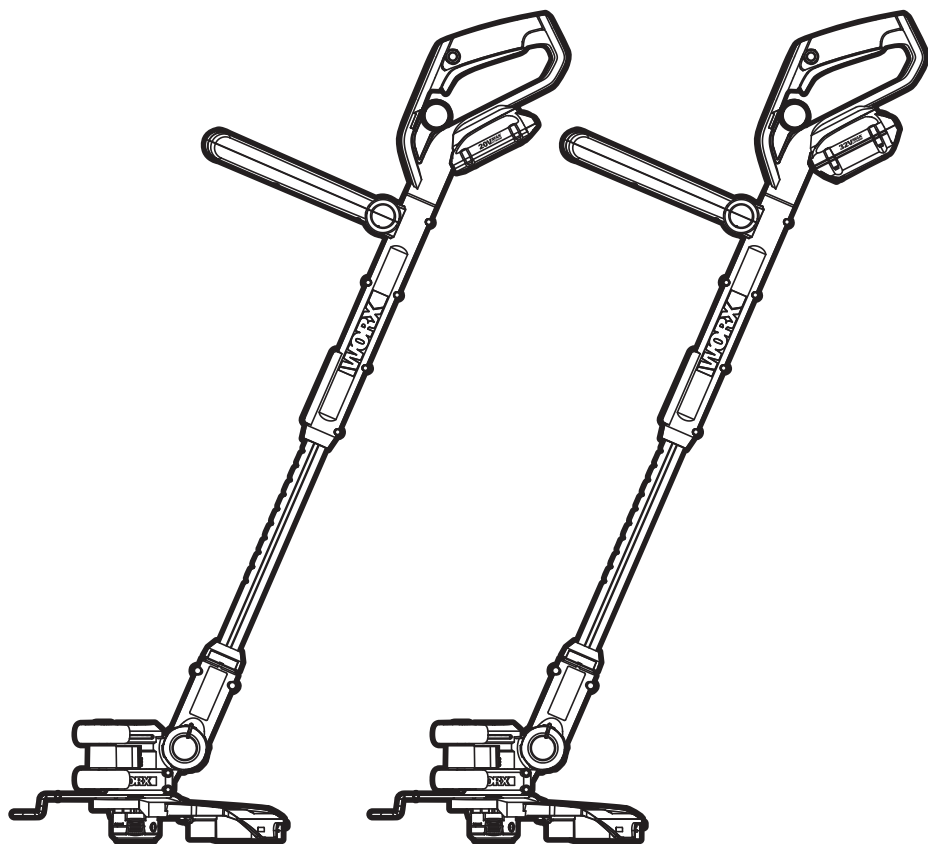

# WORX



**3 in 1 Grass Trimmer/Edger**

**EN**

**P06**

**Coupe gazon/Taille-bordure 3 en 1**

**F**

**P15**

**3 en 1 Cortadora de cesped/Ribeteadora**

**ES**

**P25**



**HELPLINE NUMBER**  
1-866-354-WORX (9679)

## WG160 WG160.1 WG175



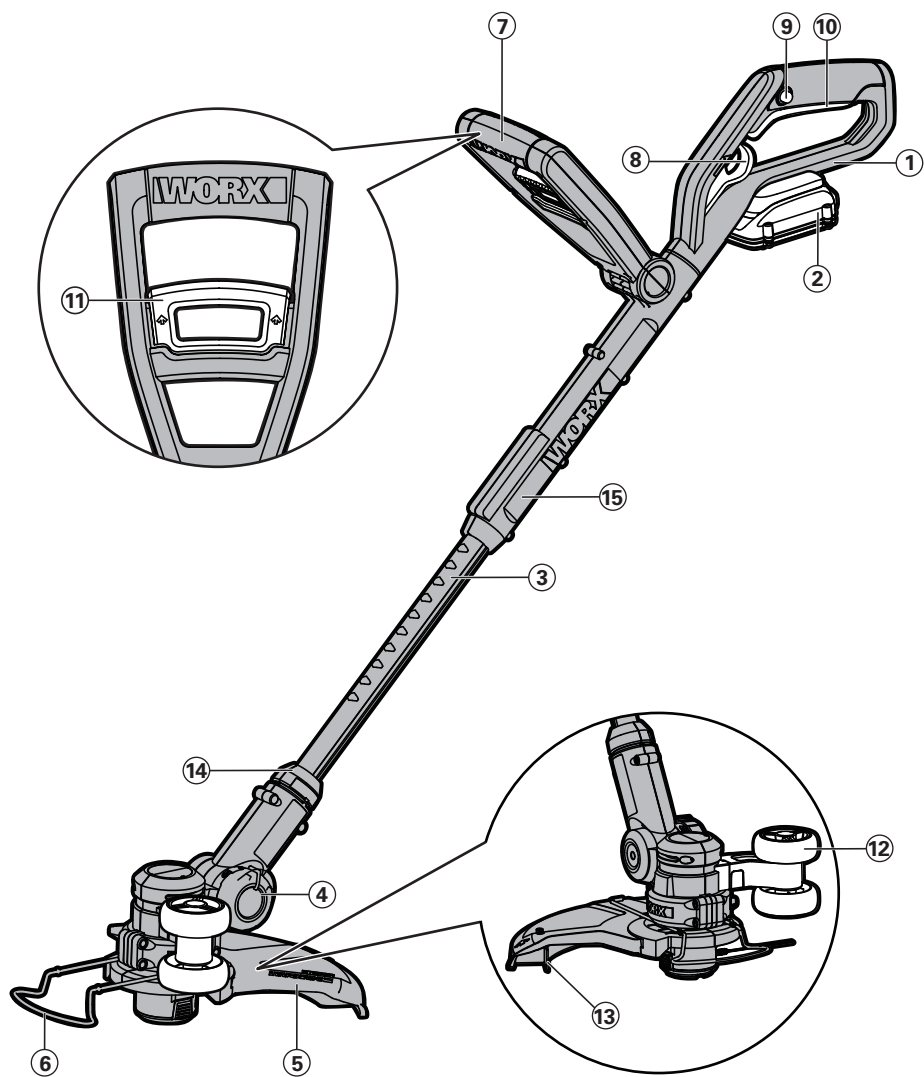

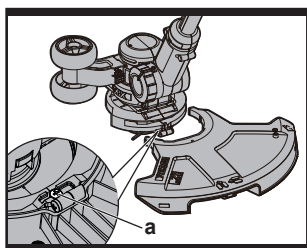

**A**

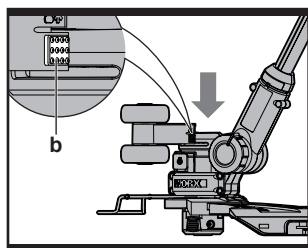

**B1**

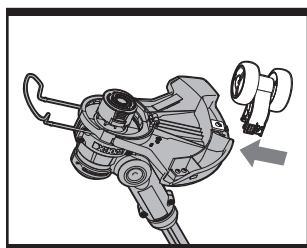

**B2**

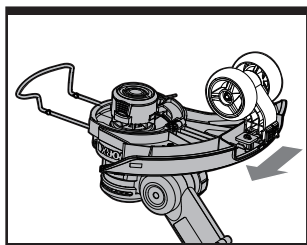

**B3**

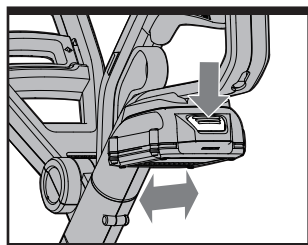

**C**

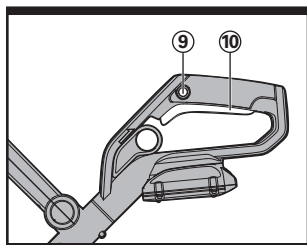

**D**

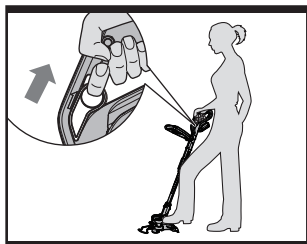

**E**

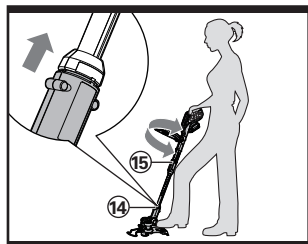

**F1**

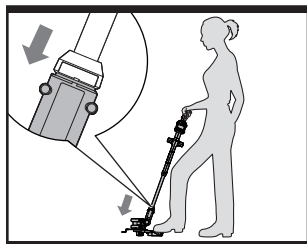

**F2**

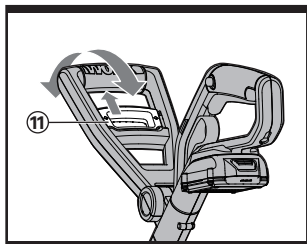

**G**

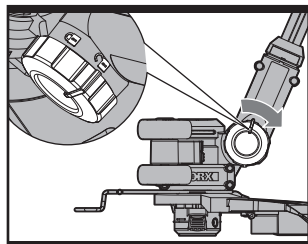

**H1**

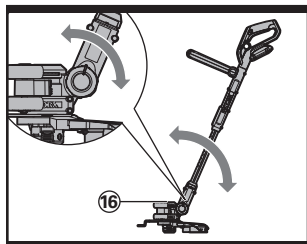

**H2**

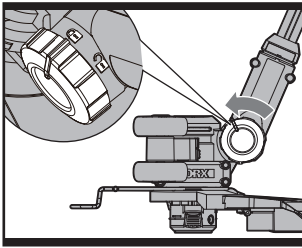

**H3**

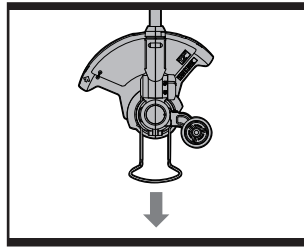

**I1**

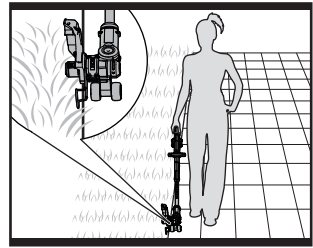

**I2**

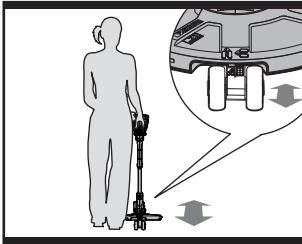

**J1**

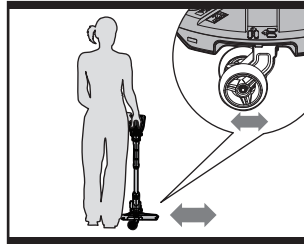

**J2**

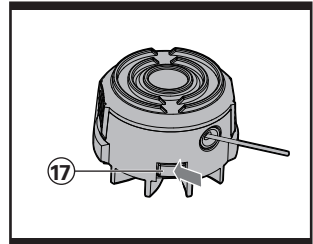

**K1**

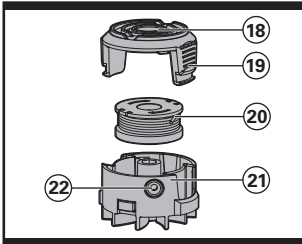

**K2**

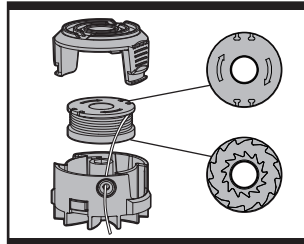

**K3**

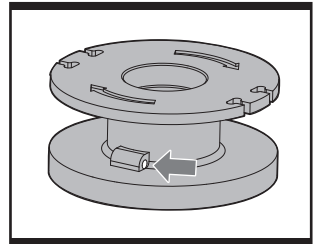

**L1**

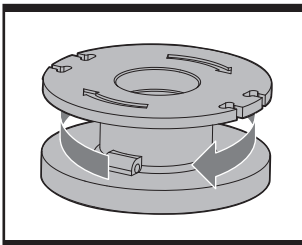

**L2**

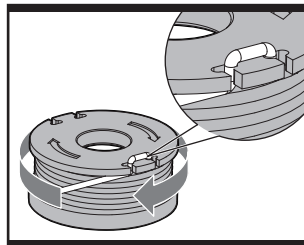

**L3**

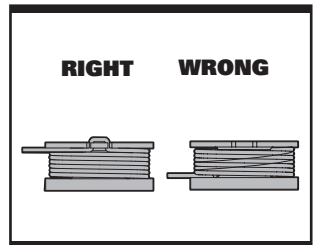



**L4**

- 
- 1. REAR HANDLE**
  - 2. BATTERY PACK**
  - 3. TELESCOPIC SHAFT**
  - 4. PIVOT HEAD LOCKING KNOB**
  - 5. SAFETY GUARD**
  - 6. FLOWER GUARD/EDGER GUIDE**
  - 7. AUXILIARY HANDLE**
  - 8. TELESCOPIC SHAFT ADJUSTMENT TRIGGER**
  - 9. LOCK OFF BUTTON**
  - 10. ON/OFF SWITCH**
  - 11. AUXILIARY HANDLE LOCKING LEVER**
  - 12. EDGER/TRIMMING SUPPORT WHEELS**
  - 13. LINE CUTTER**
  - 14. LOWER SHAFT COUPLING**
  - 15. UPPER SHAFT**
  - 16. MOTOR HOUSING OF TRIMMER HEAD**
  - 17. LINE FEED BUTTON (See Fig. K1)**
  - 18. SPOOL CAP COVER (See Fig. K2)**
  - 19. CAP RELEASE LATCH (See Fig. K2)**
  - 20. SPOOL (See Fig. K2)**
  - 21. CUTTING HEAD (See Fig. K2)**
  - 22. EYELET (See Fig. K2)**
- 

**Not all the accessories illustrated or described are included in standard delivery.**

TECHNICAL DATA

	WG160 WG160.1	WG175
Voltage	20V  Max*	32V  Max**
No load speed	7600/min	
Cutting diameter	12"	
Line diameter	0.065"	
Charging time	3hr approx.	
Machine weight	5.7lbs	6.2lbs

\* Voltage measured without workload. Initial battery voltage reaches maximum of 20 volts.  
Nominal voltage is 18 volts.  
\*\* Voltage measured without workload. Initial battery voltage reaches maximum of 32 volts.  
Nominal voltage is 28.8 volts.

ACCESSORIES

	WG160	WG160.1	WG175
Safety Guard	1		
Charger	1 (WA3732)		1 (WA3740)
Battery Pack	1 (WA3525)		1 (WA3537)
Edger/Trimming Support Wheels	1	2	1
Spool	3 (WA0004)		

Only use the appropriate accessories intended for this tool. Accessory information can be found on the product packaging, at a WORX dealer or on our website at [www.worx.com](http://www.worx.com) or by calling 1-866-354-WORX(9679).

## SAFETY INSTRUCTIONS



**WARNING!** Some dust created by power sanding, sawing, grinding, drilling and other construction activities contains chemicals known to the state of California to cause cancer, birth defects or other reproductive harm. Some examples of these chemicals are:

- Lead from lead-based paints.
- Crystalline silica from bricks and cement and other masonry products, and
- Arsenic and chromium from chemically-treated lumber.

Your risk from these exposures varies, depending on how often you do this type of work. To reduce your exposure to these chemical:

- Work in a well ventilated area.
- Work with approved safety equipment, such as those dust masks that are specially designed to filter out microscopic particles.

8



**WARNING:** When using cordless gardening appliances, basic safety precautions should always be followed to reduce the risk of fire, electric shock, and personal injury, including the following:



**WARNING: READ ALL INSTRUCTIONS**

### FOR ALL APPLIANCES

- 1) Avoid Dangerous Environment - Don't use appliances in damp or wet locations.
- 2) Don't Use In Rain.
- 3) Keep Children Away - All visitors should be kept at a distance from work area.
- 4) Dress Properly - Do not wear loose clothing or jewelry. They can be caught in moving parts. Wear protective clothing; use of work gloves, long pants, a long sleeved shirt and substantial footwear is recommended when working outdoors. Wear protective hair covering to contain long hair.
- 5) Use Safety Glasses - Always use face or dust mask if operation is dusty.
- 6) Use Right Appliance - Do not use appliance for any job except that for which

it is intended.

- 7) Avoid Unintentional Starting - Don't carry plugged-in appliance with finger on switch. Be sure switch is off when plugging in.
- 8) Don't Force Appliance - It will do the job better and with less likelihood of a risk of injury at the rate for which it was designed.
- 9) Don't overreach - Keep proper footing and balance at all times.
- 10) Stay Alert - Watch what you are doing. Use common sense. Do not operate appliance when you are tired.
- 11) Store Idle Appliances Indoors - When not in use, appliances should be stored indoors in dry, and high or locked-up place - out of reach of children.
- 12) Maintain Appliance With Care - Keep cutting edge sharp and clean for best performance and to reduce the risk of injury. Follow instructions for lubricating and changing accessories. Inspect appliance cord periodically, and if damaged, have it repaired by an authorized service facility. Inspect extension cords periodically and replace if damaged. Keep handles dry, clean, and free from oil and grease.
- 13) Check Damaged Parts - Before further use of the appliance, a guard or other part that is damaged should be carefully checked to determine that it will operate properly and perform its intended function. Check for alignment of moving parts, binding of moving parts, breakage of parts, mounting, and any other condition that may affect its operation. A guard or other part that is damaged should be properly repaired or replaced by an authorized service center unless indicated elsewhere in this manual.

### INSTRUCTION MANUAL FOR BATTERY - OPERATED GARDENING APPLIANCES

**1. The instruction manual for all battery-operated gardening appliances shall contain the following or equivalent instructions:**

- 1) Do not charge appliance in rain, or in wet locations.



- 2) Do not use battery-operated appliance in rain.
- 3) When replacing batteries, all batteries should be replaced at the same time. Mixing fresh and discharged batteries could increase internal cell pressure and rupture the discharge battery (ies). (Applies to products employing more than one separately replaceable primary battery.)
- 4) When inserting batteries into this product, the proper polarity or direction must be observed. Reverse insertion of batteries can result in leakage or explosion. (Applies to product employing more than one separately replaceable primary battery.)
- 5) Avoid Unintentional Starting – Do not insert battery with finger on switch. Be sure switch is off when inserting battery.
- 6) Remove or disconnect battery before servicing, cleaning or removing material from the gardening appliance.

**2. The instruction manual for all battery-operated products employing a detachable or separable battery shall contain the following or equivalent instructions:**

- 1) Use only the following type and size battery(ies): WORX model WA3525 (for WG160, WG160.1). WA3537 (WG175).
- 2) Do not dispose of the battery (ies) in a fire. The cell may explode. Check with local codes for possible special disposal instructions.
- 3) Do not open or mutilate the battery (ies). Released electrolyte is corrosive and may cause damage to the eyes or skin. It may be toxic if swallowed.
- 4) Exercise care in handling batteries in order not to short the battery with conducting materials such as rings, bracelets, and keys. The battery or conductor may overheat and cause burns.

**3. The instruction manual for a battery-operated gardening appliance employing a vented wet cell battery supply intended to be initially or periodically filled by the user shall include the term "CAUTION" followed by the following or equivalent: "The electrolyte is a dilute sulfuric acid that is harmful to the skin**

**and eyes. It is electrically conductive and corrosive. The following procedures should be observed:**

- a) Wear full eye protection and protective clothing.
- b) If electrolyte contacts the skin, wash it off immediately with water.
- c) If electrolyte contacts the eyes, flush thoroughly and immediately with water. Seek medical attention.

## **ADDITIONAL SAFETY RULES FOR GRASS TRIMMERS**

1. Keep guards in place and in working order
2. Keep hands and feet away from cutting area.
3. Do not use heavier lines than recommended in this manual.
4. Do not unapproved use line materials of other types – for example, metal wire, rope, and the like.

### **SAVE THESE INSTRUCTIONS**

## SYMBOLS



Warning



Read the manual



Do not expose to rain or water



Do not burn



Always charge the battery pack between temperatures 40°F (4.5°C)-105°F (40.5°C).



Do not dispose of batteries, return exhausted batteries to your local collection or recycling point

### BATTERY PACK REMOVAL AND PREPARATION FOR RECYCLING

To preserve natural resources, please recycle or dispose of batteries properly. This product contains lithium-ion batteries. Local, state or federal laws may prohibit disposal of lithium-ion batteries in ordinary trash. Consult your local waste authority for information regarding available recycling and/or disposal options.



Edging



Trimming

## ASSEMBLY

### 1. ASSEMBLY OF THE SAFETY GUARD (See Fig. A)

Remove a screw from the Guard; attach the Safety Guard to the trimmer head. Align the Guard so it slides into the slots located on the trimmer head. Turn the tool over and secure the Safety Guard onto the trimmer head with the screw (a) provided.

### 2. ASSEMBLY OF THE EDGER/TRIMMING SUPPORT WHEELS (See Fig. B1, B2, B3)

With the tool right side up, slide the Edger/Trimming Support Wheels (12) assembly onto the metal plate located on the side of the Cutting Head (See Fig. B1) or underneath the Safety Guard (5) (See Fig. B2, B3). Make sure the grooves of the Edger/Trimming Support Wheels assembly locks onto the metal plate, you will hear it click into place.

To remove the wheels assembly, press the release button (b) on the wheel and pull the wheels outside.

## OPERATION INSTRUCTIONS



**WARNING!** The charger and Battery Pack are specially designed to work together so do not attempt to use any other devices. Never insert or allow foreign metallic objects into your charger or Battery Pack connections because of electrical failure and other hazards that will occur.

### 1. BEFORE USING YOUR CORDLESS GRASS TRIMMER

Your Battery Pack is **UNCHARGED** and it must be fully charged once before it is used. The battery charger supplied is matched to the Li-Ion battery for use with this tool. Do not use another battery charger.

### 2. CHARGING YOUR BATTERY PACK

The Li-Ion battery is protected against deep discharging. When the battery is empty, the trimmer will switch off by means of a protective circuit: The trimmer head will stop rotating.

**NOTE:** In a warm environment or after heavy use, the Battery Pack may become too hot to

permit charging. Allow time for the battery to cool down before recharging.

### 3. TO REMOVE OR INSTALL BATTERY PACK (See Fig. C)

Depress the battery release button to remove Battery Pack (2) from your trimmer. After recharging, insert the Battery Pack onto trimmer's battery bracket. A simple push and slight pressure will be sufficient.

### 4. SAFETY ON/OFF SWITCH (See Fig. D)

The safety switch is locked off to prevent accidental starting. Depress the Lock Off Button (9) then depress the On/Off Switch (10) and release Lock Off Button. Your trimmer is now on. To switch off, just release the on/off switch.



**WARNING! The cutting head continues to rotate after the trimmer has been switched off; wait until it has completely stopped then lay down the tool.**

### 5. ADJUSTMENT OF THE TELESCOPIC SHAFT (See Fig. E)

Step one foot on the Safety Guard, then use one hand to pull up the Telescopic Shaft Adjustment Trigger (8), adjust the length of the Telescopic Shaft to the most comfortable length. Release the Telescopic Shaft. Adjustment Trigger to lock in position.

### 6. MAIN HANDLE ROTATION (See Fig. F1, F2)

First, hold down the lower housing with your foot and pull upward on the Upper Shaft (15). Then rotate the Upper Shaft clockwise 90 degrees (See Fig. F1) and release; the Shaft will be locked in position automatically (See Fig. F2).

### 7. ADJUSTMENT OF AUXILIARY HANDLE

Pull up the Auxiliary Handle Locking Lever (11). Hold the Locking Lever and rotate the Auxiliary Handle to the most comfortable and balanced position (See Fig. G).

Release the lever, your Auxiliary Handle has been locked.

### 8. ADJUSTMENT OF THE TRIMMER HEAD ANGLE TO THE SHAFT

(See Fig. H1, H2 & H3)



**WARNING: Make Sure the Safety Switch is Locked Off to Prevent Accidental Starting.**

To adjust the Upper Shaft angle or convert the tool from trimming mode and edging mode, unlock the Pivot Head Locking Knob by hand, and using adequate force, pull the trimmer head into the desired position, then lock the Pivot Head Locking Knob.

### 9. FLOWER GUARD/EDGER GUIDE

Pull the Flower Guard/Edger Guide out before trimming, as shown in Fig. I1.

When edging, pull Flower Guard/Edger Guide out also, and keep to a side (See Fig. I2). Before trimming or edging make sure the flower guard is locked firmly in position.

## OPERATION



**WARNING:** Always wear the eye protection. Never lean over the trimmer head. Rocks or debris can ricochet or be thrown into eyes and face and cause blindness or other serious injury. When operating unit, check for the following: Wear eye protection and heavy clothing. Hold front handle with one hand and Auxiliary Handle with the other hand. Keep unit below waist level. Work only from your right to your left to ensure debris is thrown away from you. Without bending over, keep line near and parallel to the ground (perpendicular when edging) and not crowded into material being cut.



**WARNING: Make sure that line is fed out before operation. Make sure motor is up to full speed before trimming or edging.**



**WARNING:** Only use 0.065" (1.65mm) diameter cutting line. Other sizes of line will not feed properly and will result in improper cutting head function or can cause serious injury. Do not use other material such as wire, string, rope, etc. Wire can break off during cutting and become a dangerous projectile that can cause serious injury.

## EDGER/TRIMMING SUPPORT WHEELS

There are three optional positions for the Edger/Trimming Support Wheels to attach when assisting in Trimming and Edging.

### POSITION 1: USING THE GUIDE WHEELS WHEN TRIMMING IN A FORWARD OR REVERSE DIRECTION (See Fig. J1)

Position the Grass Trimmer in the trimming position. Underneath the Safety Guard there is a metal plate that the Edger/Trimming Support Wheels will attach to. Slide the Support Wheels horizontally onto the metal plate until they lock into position so both the wheels are facing in the forward direction (See Fig. B3). The wheels should provide support when you are trimming in the forward or reverse direction.

### POSITION 2: USING THE GUIDE WHEELS WHEN TRIMMING SIDE TO SIDE

Position the Grass Trimmer in the trimming position. Underneath the Safety Guard there is a metal plate that the Edger/Trimming Support Wheels will attach to. Slide the Support Wheels vertically onto the metal plate until it locks into position (See Fig. B2). The wheels should provide support when you are trimming in a horizontal side to side direction (See Fig. J2).

**NOTE:** you could also use the machine without the guide wheels on guard when trimming.

### POSITION 3: USING THE GUIDE WHEELS WHEN EDGING (See Fig. I2)



**WARNING:** Make Sure the Safety Switch is Locked Off to Prevent Accidental Starting.

Change the tool from trimming into the edging mode, the Edger /Trimming Support Wheels (12) will attach on the side the trimmer head as shown in Fig. B1, rotate the main handle as described in **"MAIN HANDLE ROTATION"**, then unlock the Pivot Head Locking Knob, and using adequate force, pull the trimmer head into the desired position. Make sure to adjust the trimmer head angle to be in the lowest horizontal setting. Finally, lock the Pivot Head Locking Knob and position the wheel on the

ground for the edging mode. While edging, keep the Flower Guard/Edger Guide aligned with the sidewalk edge, this will assist to edge in a straight path. Only the tip of the line will make contact with area being worked on. Do not force the line. The edging wheels help protect the unit and keep the unit from contacting the ground. Take extra caution while edging, as objects can be thrown from the trimmer line.

## AUTOMATIC LINE FEED SYSTEM

When initially switching on the trimmer, a small length of line is fed out. Each time the tool is started from rest it will advance about 0.25 inches of trimmer line.

A 'clattering' noise will be heard when the lines hit the Line Cutter. **DO NOT BE ALARMED** this is quite normal. After about 5 seconds the line will be cut to the correct length and the noise will reduce as the motor gains full speed.

If the noise of the line being cut can't be heard, more line will need to be fed out.

To feed more line, it is first necessary to allow the trimmer to stop completely; it must come to a complete rest, then restart, allowing the motor to reach full speed.

Repeat above until you hear the line hitting against the Line Cutter.

## TO MANUALLY FEED THE LINE (See Fig. K1)

Turn off the trimmer and remove the battery. If required, line can be fed out manually.

To operate, press and release manual Line Feed Button (17), while gently pulling out the line until it is long enough to reach the Line Cutter.

If the line extends past the Line Cutter, too much line has been fed out.

If too much line is fed out, remove the Spool Cap and turn Spool counter-clockwise until the line is at the desired length.

## TO REMOVE THE SPOOL CAP COVER (See Fig. K2)

Press and hold in the two Cap Release Latches (19) (See Fig. K2).

Pull the Spool Cap Cover (18) away from the

Cutting Head (21). Keep the Spool Cap Cover and the inside of the Cutting Head clean from debris. To replace the Spool Cap Cover, press it firmly onto the Spool Holder. Ensure that it is correctly connected by trying to remove it without depressing the two Cap Release Latches.

### **REPLACE THE TRIMMER LINE AND SPOOL (See Fig. K3).**

Turn off the trimmer and remove the battery. Remove Spool Cap Cover.

For your convenience it is recommended you buy replacement spools with the trimmer line preinstalled. You can order your Free Spools for Life WORX spools at [www.worx.com](http://www.worx.com) or by calling 1-866-354-WORX(9679).

Remove the old Spool from Spool Holder. Clear any broken line or cutting debris from the spool area. Pull the line from the new replacement Spool through the eyelet of the Spool Holder. Place new Spool into the holder with the **cut out areas of the Spool facing inward or down. When installed into the Spool Holder, the smooth side of the Spool should be visible.**

Release line from cleat on the Spool. Refit the Spool Cap Cover.

### **TO MANUALLY WIND LINE (See Fig. L1-L4)**

Take approximately 10ft (3m) of line. Insert 5/8" (15mm) of line into the Spool holes and wind line in the direction of the arrows on the top of the Spool.

Leave approximately 4" (100mm) of line unwound and place into the cleat.

Ensure that the line is neatly coiled on the Spool. Failure to do so will impair the efficiency of the automatic line feed.

Then fit the Spool as described above in **"Replace the trimmer line and Spool"**

## **MAINTENANCE**

After use, disconnect the battery from the tool and check for damage.

Your power tool requires no additional lubrication or maintenance. There are no

user serviceable parts in your power tool. Never use water or chemical cleaners to clean your power tool. Wipe clean with a dry cloth. Always store your power tool in a dry room temperature location. Keep the motor ventilation slots clean. Keep all working controls free of dust.

## TROUBLESHOOTING

The following table gives problems and actions that you can perform if your machine does not operate correctly. If these do not identify and correct the problem, contact your WORX Customer Service at 1-866-354-WORX.



**WARNING:** Switch the machine off and remove the battery prior to any troubleshooting.

Problems	Possible Causes	Corrective Action
Trimmer fails to operate.	Battery discharged. Battery too hot/cold. Motor is broken. Internal wiring of machine damaged.	Recharge battery; also see the content in charger manual. Allow to cool/warm. Contact Service Agent. Contact Service Agent.
Trimmer runs intermittently.	Motor is broken. Battery not fully charged. On/Off switch defective.	Contact Service Agent. Recharge battery. Contact Service Agent.
Excessive vibrations/noise.	Machine defective. Line spool is not wound well.	Contact Service Agent. Rewind the line. See "To fit spool and line assembly."
Cutting time per battery charge too short.	Battery has not been used for long period or only charged for short term. Grass is too high. Battery defective.	Fully charge battery; also see the content in charger manual.  Cut in stages. Replace the battery.
Machine does not cut.	Line broken. Battery not fully charged.  Motor is broken (speed is too low). Grass entangled around cutting head.	Replace the line. Recharge battery; also see the content in charger manual. Contact Service Agent. Remove grass.
Continuous lighting of the battery charge indicator. No charging procedure possible.	Battery not (properly) inserted.  Battery contacts contaminated.  Battery defective.	Properly insert battery into battery charger. Clean the battery contacts or replace the battery. Replace the battery.
Battery charge indicator does not light up.	Plug of battery charger not plugged in (properly). Socket outlet, mains cable or battery charger defective.	Insert mains plug (fully) into the socket outlet. Check the mains voltage; have the battery charger checked by an authorized after-sales service agent.
Auto feed does not work	Cutting line is not wound well. The line is tangled.  Line is used up.	Manually feed the line, if still can not feed out, remove the Spool out and rewind the line. Replace with a new spool of line.