

# **Sound<sup>2</sup>** by **JACKCO**

ZT51000

---

**User Manual**



# Product Layout

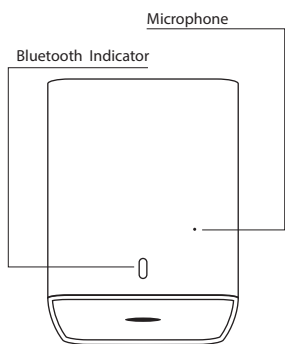

Front

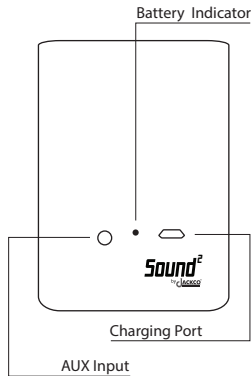

Back

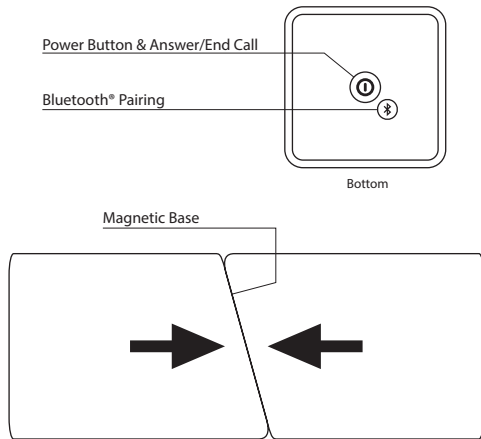

## Table of Contents

Product Layout.....	1
Introduction.....	2
Features.....	3
Safety Information.....	4
Set-up.....	5
-Turning Speakers on.....	5
-Pairing with Bluetooth Device.....	6
Taking Calls.....	7
Connecting via 3.5mm AUX in input.....	8
Recharging Battery.....	8
Factory Reset Pairing Procedure.....	9
Troubleshooting.....	10
Technical Specifications.....	13
FCC Notice.....	13
Environmental Protection.....	14
Lithium Battery Caring Tips.....	14
Warranty.....	15

## Contents of the box

- **Sound<sup>2</sup>** Bluetooth Speakers
- USB Charging Cable
- 3.5mm audio input cable
- Carrying Pouch

### A. Introduction:

**Sound<sup>2</sup>** by Jackco is a pair of Bluetooth speakers. Unique in a way that lets you cut the cord and enjoy true stereo music on the go. Connect to your smartphones, tablets, iPods, or laptops and just hit 

## B. Features

- Two speakers wirelessly connected via Bluetooth
- 2.0 ch High Fidelity Stereo Sound
- Each speaker can be used separately
- Built in Microphone for phone calls and video conferencing
- AUX input
- Rechargeable lithium battery
- Magnetic base allows you to attach the speakers to steel surfaces

**Sound<sup>2</sup>** supports the following standards



- Bluetooth 2.1+
- Advanced Audio Distribution profile (A2DP)
- Hands-free Audio (HFP) and Headset Profiles (HSP) for hands free calling capability
- Audio Video Remote Control Profile (AVRCP) for wireless audio and video playback control

## C. Safety Information

- Do not expose the speakers to rain, moisture or any liquid. Exposure to liquid or moisture may cause the speakers to fail and increase the risk of electrical shock or fire.
- Do not expose the speakers to open flame, such as candles, camp fire, etc.
- Under no circumstances should the users make any change or modification to the product or its accessories. Any changes made may compromise safety, affect the performance of the product and void the warranty.
- In case the battery begins to leak, do not allow your body parts to come in contact with the liquid, If contact has been made, please wash with plenty of water and seek medical advice.
- Do Not expose the product to excessive heat, such as inside a car under direct sunlight where temperature may exceed 140°F (60°C) degrees. Battery under extreme heat may generate more heat, rupture, or ignite. Storing the speakers under such condition may result in degradation in performance and shorter battery life.
- This product contains magnets, which can be harmful to persons wearing pacemaker.
- Hearing damage can result from prolong exposure to loud music, please turn down the volume.
- The speakers contains lithium batteries, please dispose the speakers properly, following local regulations. Do not incinerate.



## D. Set-up

### Turning the Speakers On and Off:

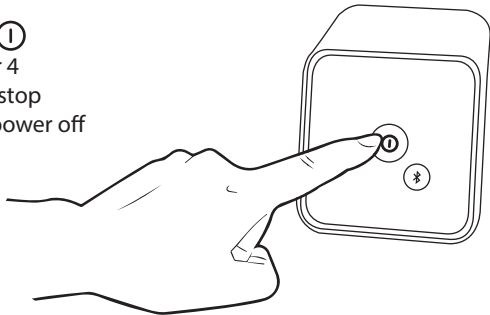
1. Power on: Lightly press and hold  (Power Button) of both speakers at the same time for 4 seconds, Bluetooth Indicator will start blinking and accompanied by power on ring tone.
2. Power off: Lightly press and hold  (Power Button) of one speaker for 4 seconds, Bluetooth indicator will stop blinking and accompanied with power off ring tone.



## Pairing with Bluetooth Equipped Device:

1. Pairing the 2 speakers: Press and hold  (Power Button) of both speakers until power is on, it will enter pairing mode for 10~30 seconds, and accompanied by the Bluetooth indicator fast blinking. Once it is paired, Bluetooth indicator will blink slowly and accompanied by a ring tone (Pairing time will vary depending on external interference)
2. Press the  (Bluetooth Pairing) once, it will enter into pairing mode with cell phone or Bluetooth device. When the speakers have paired with your device successfully, you be prompted with a ring tone. On one speaker Bluetooth indicator becomes solid on (Master: Left Channel), while the other speaker will blink on-off once every 3 seconds (Slave: Right Channel).

Note: You may see two **Sound<sup>2</sup>** devices on your Apple iPhone, iPad, or iPod. You can pick either one of the devices to pair.

- Press and hold  (Bluetooth Pairing) can cancel pairing with cell phone.
- If your device prompts you for a passcode, please enter 0000.

## Taking Calls with your **Sound<sup>2</sup>** connected to your phone:

When your phone receives an incoming call, a ring tone alert will come from your **Sound<sup>2</sup>** speaker.

- To accept a call:
  - Press the **⓪** (Power Button) on the master speaker.
- To end a call:
  - Press the **⓪** (Power Button) on the master speaker.

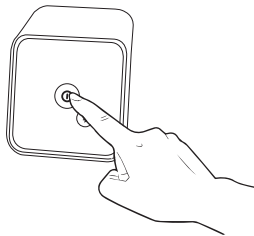

To reject a call or use call waiting feature, please revert to your phone controls.



## E. Connecting to *Sound<sup>2</sup>* via 3.5mm AUX input:

You can use *Sound<sup>2</sup>* speakers for music play with any device that has 3.5mm Audio out port. Simply plug in the 3.5mm cable (included) into the speaker and into your device then play music.

## F. Recharging Battery:

Connect the provided USB cable to the charging port on the speakers and a USB charging block. Battery Indicator glows red when battery is charging, and indicator changes to green when battery is full.

The charging time is approximately 3 hours from an empty battery

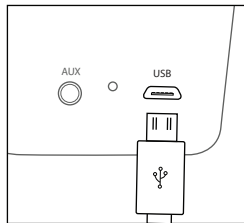

## G. Factory Reset Pairing Procedure:

### 1. Power On

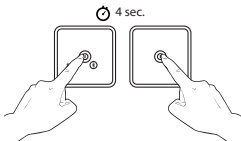

Press and hold **(I)** for 4 seconds to power on the speakers

### 2. Pairing Speakers

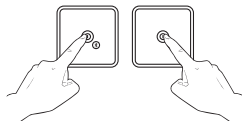

*Note: Please turn off the Bluetooth connectivity on your device.*

**A.)** Press **(I)** again on both speakers. Bluetooth Indicator will be fast blinking accompanied by a ringtone.

30~60 sec.

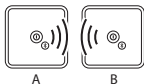

**B.)** Allow 30~60 seconds for the speakers to pair with each other. Once it is paired Bluetooth indicator will blink slowly and accompanied by a ringtone.

### 3. Pair with Device

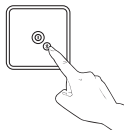

Press the **(B)** button on one of the speakers to pair with your bluetooth device.

### 4. Complete Pairing

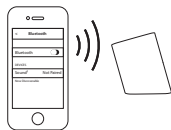

Turn on Bluetooth and search for "Sound<sup>2</sup>" and click "Pair". Play music to confirm that the pairing process is complete. If not, repeat the process.

## H. Troubleshooting

Problem	Solution
No audio from the <i>Sound<sup>2</sup></i> speakers	<ul style="list-style-type: none"><li>• Check if the Bluetooth device and <i>Sound<sup>2</sup></i> speakers are powered on and paired. Increase volume from your Bluetooth device.</li></ul>
Music playing through the speaker is intermittent	<ul style="list-style-type: none"><li>• Make sure the distance between the Bluetooth device and the <i>Sound<sup>2</sup></i> speaker is within the 30 foot range, or check if there are any device/equipment that generates electromagnetic interference.</li></ul>
A beep is heard during music play	<ul style="list-style-type: none"><li>• Battery is low, turn off speakers and recharge the battery.</li></ul>

Problem	Solution
Music is intermittent, when the <i>Sound<sup>2</sup></i> is connected to Apple devices, i.e. Apple iPad, iPhone, iPod.	<ul style="list-style-type: none"><li>• Restart the pairing process again, and check “forget this device” in the Bluetooth setting. iOS is able to pair with 2 separate Bluetooth devices at the same time. If there are 2 devices connected to one Apple Bluetooth device at the same time, signal interference will occur. To avoid this when pairing with the speakers again, please turn off other unused Bluetooth devices.</li></ul>
Poor sound quality or sound is distorted.	<ul style="list-style-type: none"><li>• Lower the music volume, or if speakers are playing through the AUX line, make sure the line is fully plugged in.</li></ul>

Problem	Solution
Only one speaker has sound	<ul style="list-style-type: none"> <li>The <b>Sound<sup>2</sup></b> speakers are not properly paired. Please power off both speakers and refer back to Section D, set-up to start the pairing procedures again. The <b>Sound<sup>2</sup></b> speaker should pair each other first, then with the Bluetooth device.</li> </ul>
Only one speaker has sound; both speakers have solid on Bluetooth indicator.	<ul style="list-style-type: none"> <li>This shows that the 2 speakers paired with 2 different Bluetooth devices. Please turn off other prior paired Bluetooth devices (i.e. phone or tablet within the 30ft vicinity). Then restart the pairing procedures again (refer to quick start guide/section D in manual).</li> </ul>

*Note: If your question has not been answered, please refer to our website for more information. [www.jackco.com](http://www.jackco.com)*

## I. Technical Specifications

Dimensions (Detached)	2.45" L x 2.45" W x 3.3" H
Charge Current	300mA
Charge Voltage	5V DC
Battery	Lithium polymer 800 mAh
Working Temperature	-4°F - 113°F (-20°C - 45°C)
Working Humidity	5% - 95%
Working Hours*	About 6 hours (at 60% volume)
Range	30 ft.
Bluetooth Version	2.1+EDR, A2DP, AVRCP, HSP, HFP
Output Power	3W + 3W

*\*Working hours are dependent on the speaker volume. The working hours at max volume decreases significantly.*

## J. FCC Notice

This device complies with part 15 of the FCC rules. Operation is subject to the following two conditions: (1) This device may not cause harmful interference and (2) this device must accept any interference received, including interference that may cause undesired operation. **FCC ID: 2ACZPZT51000**

## K. Environmental Protection



Do not dispose of the product with household waste.



Do not incinerate. Keep away from fire.

## L. Lithium Battery Caring Tips

- This product uses the micro USB charge port, and built-in lithium battery. We recommend that the battery is fully charged and discharged during first three uses to ensure the battery is in it's best performance.
- When charging is complete, unplug the USB cable on the speakers.
- Please do not place the **Sound<sup>2</sup>** speaker in extreme environments. The speakers perform best when operating at room temperature, 70° F (20° C).



## Limited Six (6) Month Warranty

Jackco Transnational Inc. warrants "SOUND<sup>2</sup> by JACKCO" branded products to the original purchaser against any manufacturing defect in material or workmanship for a period of six (6) months from the original date of purchase. If the defective product is determined to be covered under this warranty, it shall be repaired or replaced at manufacturer's discretion without charge. Provided that the product must be returned with proof of purchase and freight prepaid when returned to the manufacturer. This warranty shall not apply to damage due to accident, negligent use, lack of maintainance, abuse or applications other than the specific function the product is designed for.

No other warranties, expressed or implied, including those of merchantability or fitness for particular purpose shall be applicable to Jackco except as specifically stated herein. In no event shall Jackco be liable to any party for any special, direct, indirect, consequential, punitive damage of any nature caused by the sale or use of the equipment, tool, or product.

Note: This warranty gives the original purchaser specific legal rights which may vary from state to state.

Please visit our website at [www.jackco.com/warranty.html](http://www.jackco.com/warranty.html) to submit your RMA request.

iPad, iPhone, and iPod are trademarks of Apple Inc., registered in the U.S. and other countries. The Bluetooth word mark and logos are owned by the Bluetooth SIG, Inc. Other trademarks and trade names are those of their respective owners.