



Panel Express Panel Cart Owner's Manual

- 1 Check all screws are tight prior to every use, especially the initial use.
- 2 Check inflation of pneumatic tires, maximum 30 psi.
- 3 Do not over load the cart. 700 lbs. is the maximum load.
- 4 With the adjusting brace locked open, the maximum load is 200 lbs.
- 5 If loading a sheet larger than 5 ft. tall, ensure the brace lock is not used. (there is a possibility of the cart falling over if the center of gravity is outside the large tires caused by the leaning of a very tall sheet like loading the 4 ft. side of a 4 X 8 sheet.

Tips and tricks

1. When loaded push the sheet from behind with the big pneumatic tires first.
2. When going over obstacles like air hoses, you may want to slightly tilt the load forward to un-weight the small rear wheels.
3. When not wanting to use the brace lock arm, an easy way to store it so it is not lost is to remove it, turn it upside down so the notch is facing up and then reinstall it. This way the arm does not get lost or misplaced.
4. The lock up arm has a load limit of 200 lbs. If putting single sheets of material in the cart that are greater than 200 lbs, the notch on the swing arm should face up so that it will not lock. **Warning, The center swing arm will break if loads greater than 200 lbs. are used on the cart with the brace locked open.** To lock the adjusting brace open, make sure the locking arm notch is faced down. Pull the adjusting brace all the way open until the notch in the locking arm drops down and catches on the side of the cart. To close the adjusting brace when locked open, kick up on the locking arm to disengage.

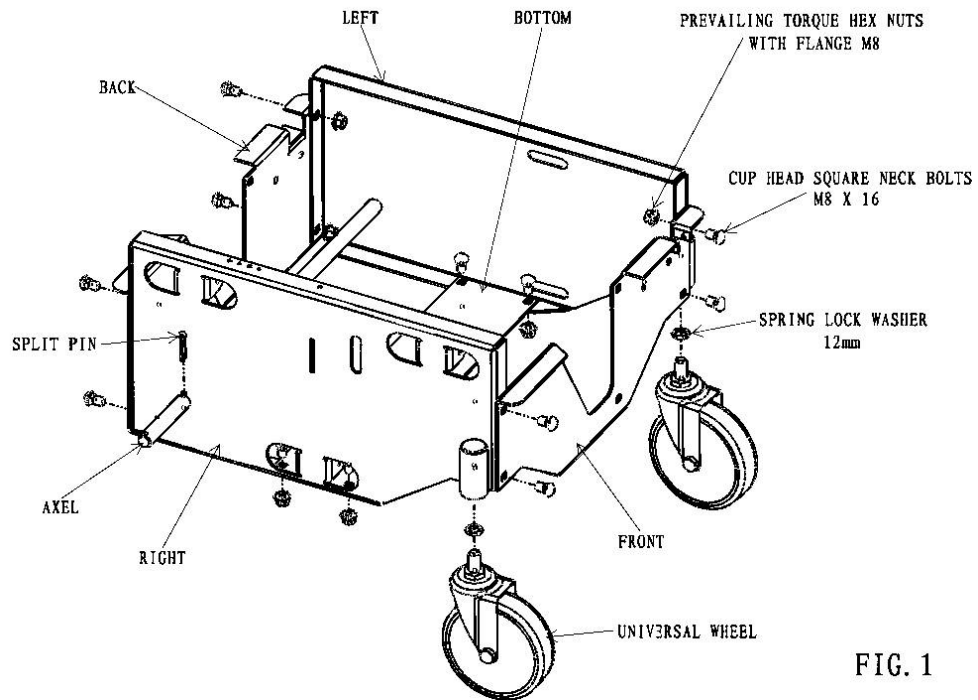

FIG. 1

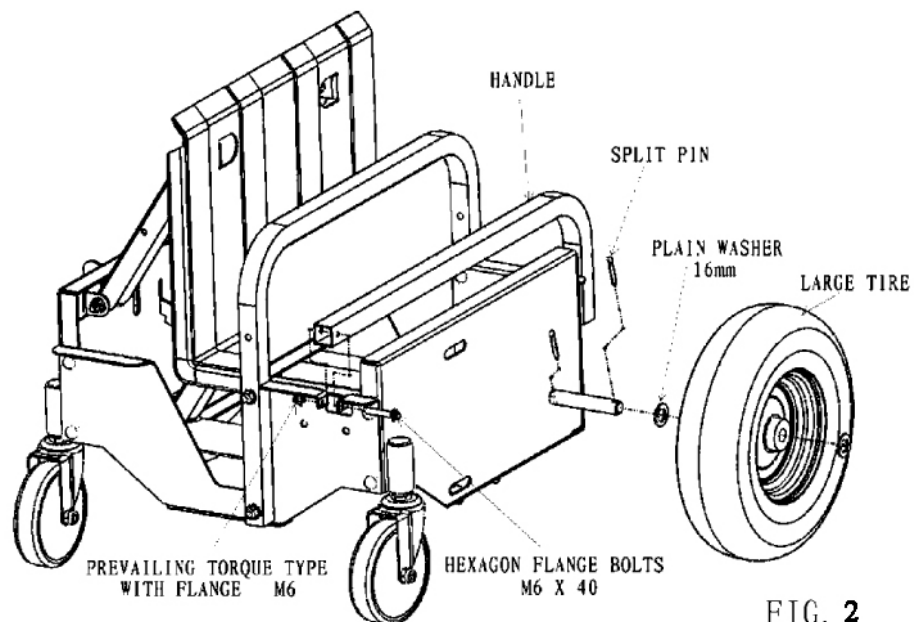
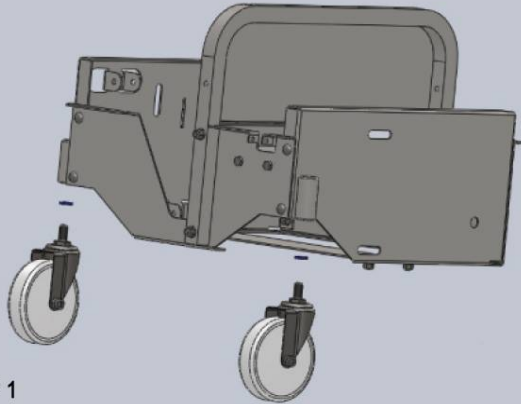

FIG. 2

STEP BY STEP INSTRUCTIONS



STEP 1

Place a 12 mm lock washer on each threaded end of the caster. Screw the caster into the front of the cart and use the provided 21mm wrench to tighten the casters.

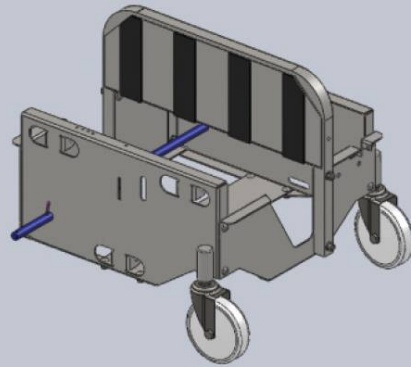

STEP 2

Insert the axel into the body of the cart and lock it in using the cotter pins on the inside holes (holes closest to the cart). Note: Be sure to slightly flair the ends of the cotter pin after inserting them so they don't fall out.

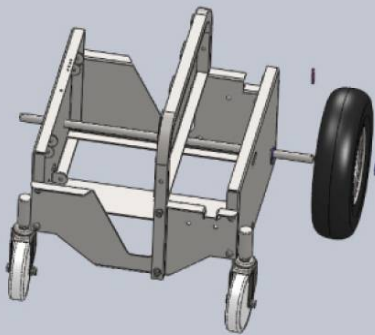

STEP 3

Place a 16 mm washer on the axel, followed by the tire, followed by another washer and then insert a cotter pin in the outer hole to lock the tire in place. Note: Be sure to slightly flair the ends of the cotter pin after inserting them so they don't fall out.

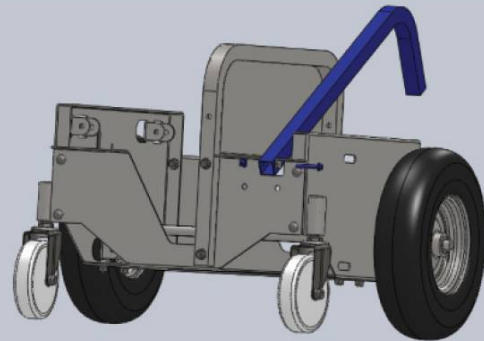

STEP 4

Use the 6 mm screw and lock nut to attach the handle to the cart. The end of the handle should put down when laying flat on the cart. Use the wrenches provided to thread the nut onto the bolt. Tighten until you feel the nut get harder to turn when the bolt goes into the nylon section of the nut.

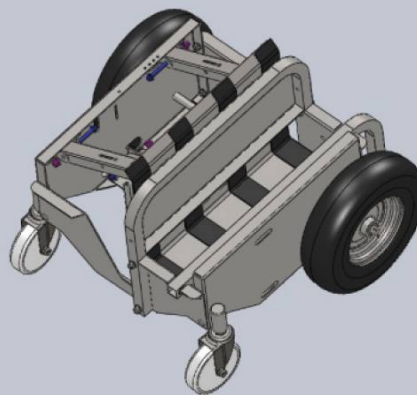

STEP 5

Use the wrenches provided to connect the end of the center swing arm to the cart and adjusting brace. Use the other swing arms as an example.

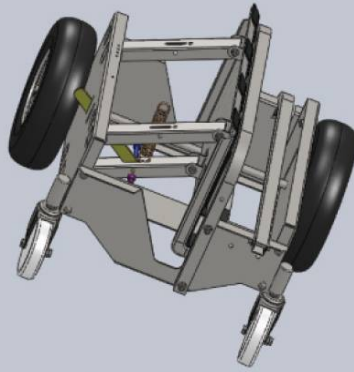

STEP 6

Ensure the spring is attached to the swing arm prior to attaching the "locking arm". The spring should be fed through the slot in the swing arm and through the top hole. Note: The locking arm has a load limit of 200 lbs. If putting single sheets of material in the cart that are greater than 200 lbs, the notch on the locking arm should face up so that it will not lock. Feed the locking arm through the side slot of the cart and through the slot in the center swing arm. Use the 8 mm bolt and lock nut through the side holes of the center swing arm to attach the lock up arm to the cart. Hand tighten the lock nut so the lock up arm can be easily reversed as needed.

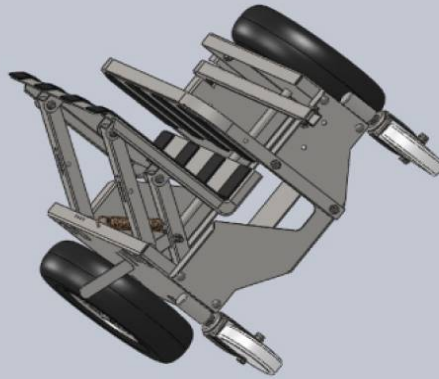

STEP 7

The locking arm has a load limit of 200 lbs. If putting single sheets of material in the cart that are greater than 200 lbs, the notch on the locking arm should face up so that it will not lock. **Warning, The center swing arm will break if loads greater than 200 lbs. are used on the cart with the brace locked open.** To lock the adjusting brace open, make sure the locking arm notch is faced down. Pull the adjusting brace all the way open until the notch in the locking arm drops down and catches on the side of the cart. To close the adjusting brace when locked open, kick up on the locking arm to disengage it.

Packing List

No.	Part Name	Specification	Quantity
1	universal wheel		2
2	axel		1
3	large tire		2
4	handle		1
5	spring		1
6	spring lock washer	12mm	2
7	split pin	4 x 28mm	4
8	plain washer	16mm	4

Installation Instructions for Optional Accessories



TOOL BOX:

Insert tool box with the angled side towards the center of the cart in the opening under the "J" shaped handle.

Line up tool box holes with hole in the panel cart and insert screws.



PIVOTING SHELF:

Insert the shelf on the where the "J" shaped handle is located.

Line up shelf holes with holes in the panel cart. Make sure the shelf is placed on the inside of the panel cart's frame.

There are three (3) washers that will need to be inserted on the shelf's bolt as listed below:

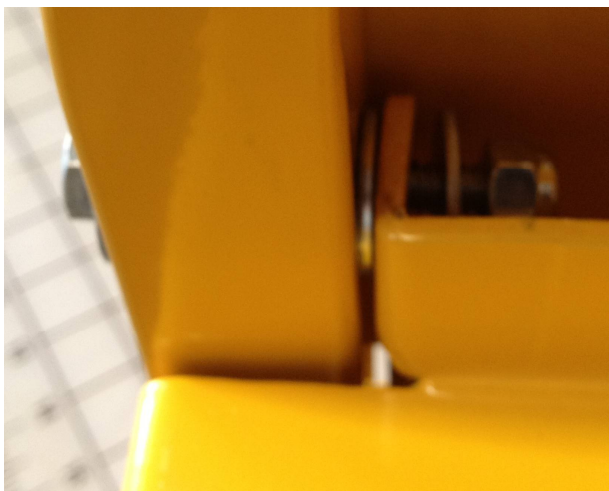

Place the 1st washer on the bolt and insert bolt until it clears the square tube of the frame. Insert the 2nd bolt between the square tube and the shelf. Then push the bolt completely through the shelf and add the 3rd washer and lock nut.

Tighten lock nut securely making sure that the shelf can still open and close.