



SPX Corporation  
 655 Eisenhower Drive  
 Owatonna, MN 55060-0995 USA  
 Phone: (507) 455-7000  
 Tech. Serv.: (800) 533-6127  
 Fax: (800) 955-8329  
 Order Entry: (800) 533-6127  
 Fax: (800) 283-8665  
 International Sales: (507) 455-7223  
 Fax: (507) 455-7063  
<http://www.otctools.com>

**SPX POWER TEAM**

SPX Corporation-Fluid Power  
 5885 11th Street  
 Rockford, IL 61109-3699 USA  
 Phone: (815) 874-5556  
 Tech. Serv.: (800) 477-8326  
 Fax: (800) 765-8326  
 Order Entry: (800) 541-1418  
 Fax: (800) 288-7031  
<http://www.powerteam.com>

Form No. 104820

**Parts List & Instructions**

for:	<b>1155</b>	<b>1176</b>	<b>1181</b>
	<b>1156</b>	<b>1177</b>	<b>1189</b>
	<b>1157</b>	<b>1178</b>	<b>7947</b>
	<b>1158</b>	<b>1179</b>	<b>7948</b>

**Slide Hammer Puller Sets**

Slide hammer puller sets have several pulling attachments to give the user various methods for pulling, maintenance, and repair applications; the slide hammer exerts force when needed. Recommended assemblies for the slide hammer are shown in this parts list. *Note: Each set does not include all the attachments shown. Refer to the back of this sheet for the contents of each set.*

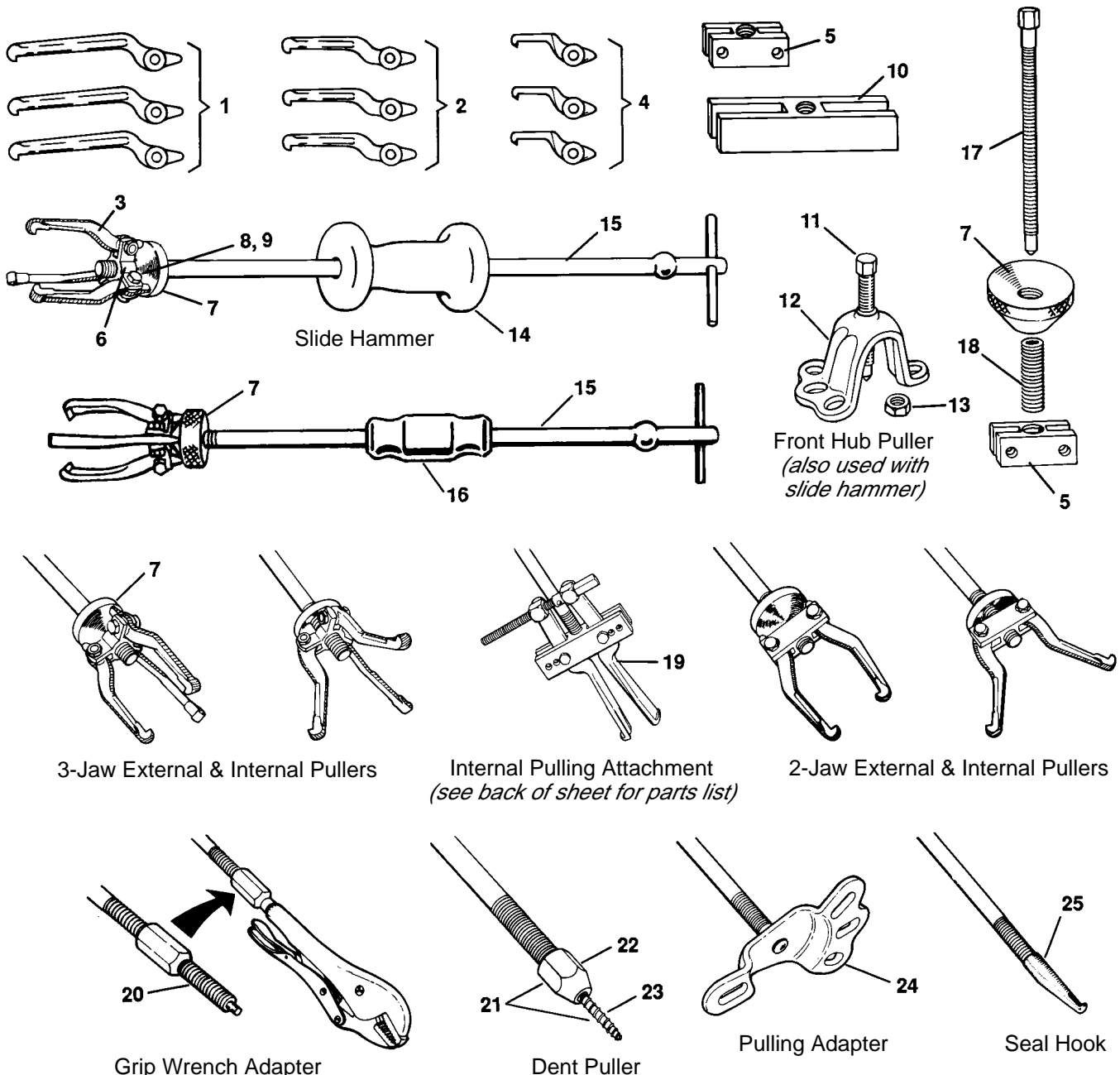

Front Hub Puller  
*(also used with slide hammer)*

3-Jaw External & Internal Pullers

Internal Pulling Attachment  
*(see back of sheet for parts list)*

2-Jaw External & Internal Pullers

Grip Wrench Adapter

Dent Puller

Pulling Adapter

Seal Hook

**Note:** If the grip wrench has a double lead thread, it will be necessary to order a double lead adapter (218875).

Item No.	Part No.	Description	Catalog Slide Hammer Set No.										
			1155	1156	1157	1158	1176	1181	1178	1179	1189	7947	7948
1	44148	6-1/2" Internal / External Puller Jaw							3		3		3
2	44195	4-1/8" Internal / External Puller Jaw							3				
3	34698	3-3/4" Internal / External Puller Jaw						3	3	3	3	3	3
4	32054	2-3/8" Internal Puller Jaw							3		3		3
5	27241	Cross Nut						1	1	1	1	1	1
6	24544	3-Way Puller Head						1	1	1	1	1	1
7	24545	Cone						1	1	1	1	1	1
8	10384	Hex Jam Nut						3	3	3	3	3	3
9	22021	Hex Hd. Cap Screw						3	3	3	3	3	3
10	36578	Cross Block							1				
11	24833	Forcing Screw									1		1
12	520968	Puller Head									1		1
13	10394	Hex Jam Nut									1		1
14	34331	Hammer (5 lb.)	1			1		1		1	1	1	1
15	208627	Shank & T-bar Assembly	1	1	1	1	1	1	1	1	1	1	1
16	22185	Hammer (2-1/2 lb.)		1	1			1					
17	309321	Forcing Screw									1		1
18	215895	Sleeve									1		1
19	1152	Internal Pulling Attachment (see below)			1	1							
20	205378	Vise Grip Adapter (single-lead thread) <b>Note:</b> If the grip wrench has a double-lead thread, it will be necessary to order a double lead adapter (218875).								1	1	1	1
21	205377	Dent Puller (contains Items 22 & 23)								-	-		
22	205399	Retainer								1	1	1	1
23	104427	Self-Tapping Screw								1	1	1	1
24	31599	Pulling Adapter								1	1	1	1
25	27315	Seal Hook							1	1	1	1	1

Internal Pulling Attachment (1152)

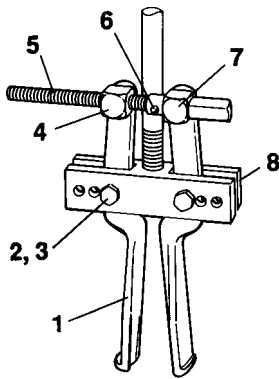

Item No.	Part No.	No. Req'd	Description
1	32137	2	4" Clearance Jaw
2	10054	2	Hex Hd. Cap Screw (3/8-24 x 1-1/2" Lg.)
3	10386	4	Jam Nut (3/8-24)
4	24847	1	Tapped Swivel
5	24846	1	Adjusting Screw
6	11560	1	Roll Pin
7	24848	1	Plain Swivel
8	33482	1	Puller Yoke

Safety Precautions



**CAUTION:** To avoid injury when using this tool,

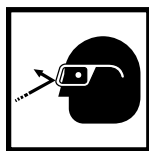

- Wear eye protection that meets ANSI Z87.1 and OSHA standards.
- Cover the work with a protective blanket or canvas to reduce danger from breaking parts.

- Adjusting strap bolts must be tight on puller jaws.
- Puller legs and jaws must be in-line and the setup must be rigid.
- Apply force gradually. If maximum force has been applied and the work piece has not moved, use a puller with a larger capacity. Do NOT hit the part with a hammer in an attempt to jar it loose.

**Important:** When using the jaws in the spread or reversed position as shown, thread the cone as close to the puller head as possible to ensure a firm grip on the part.

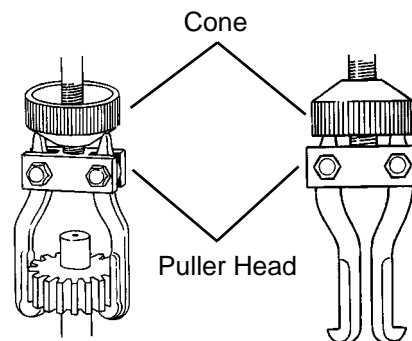

Jaws Spread

Jaws Reversed