

www.mkdiamond.com

MK-170 TILE SAW OWNER'S MANUAL PARTS LIST & OPERATING INSTRUCTIONS



Revision 103	05.2015
Manual 157243	

Caution: Read all safety and operating instructions before using this equipment. This parts list **MUST** accompany the equipment at all times.

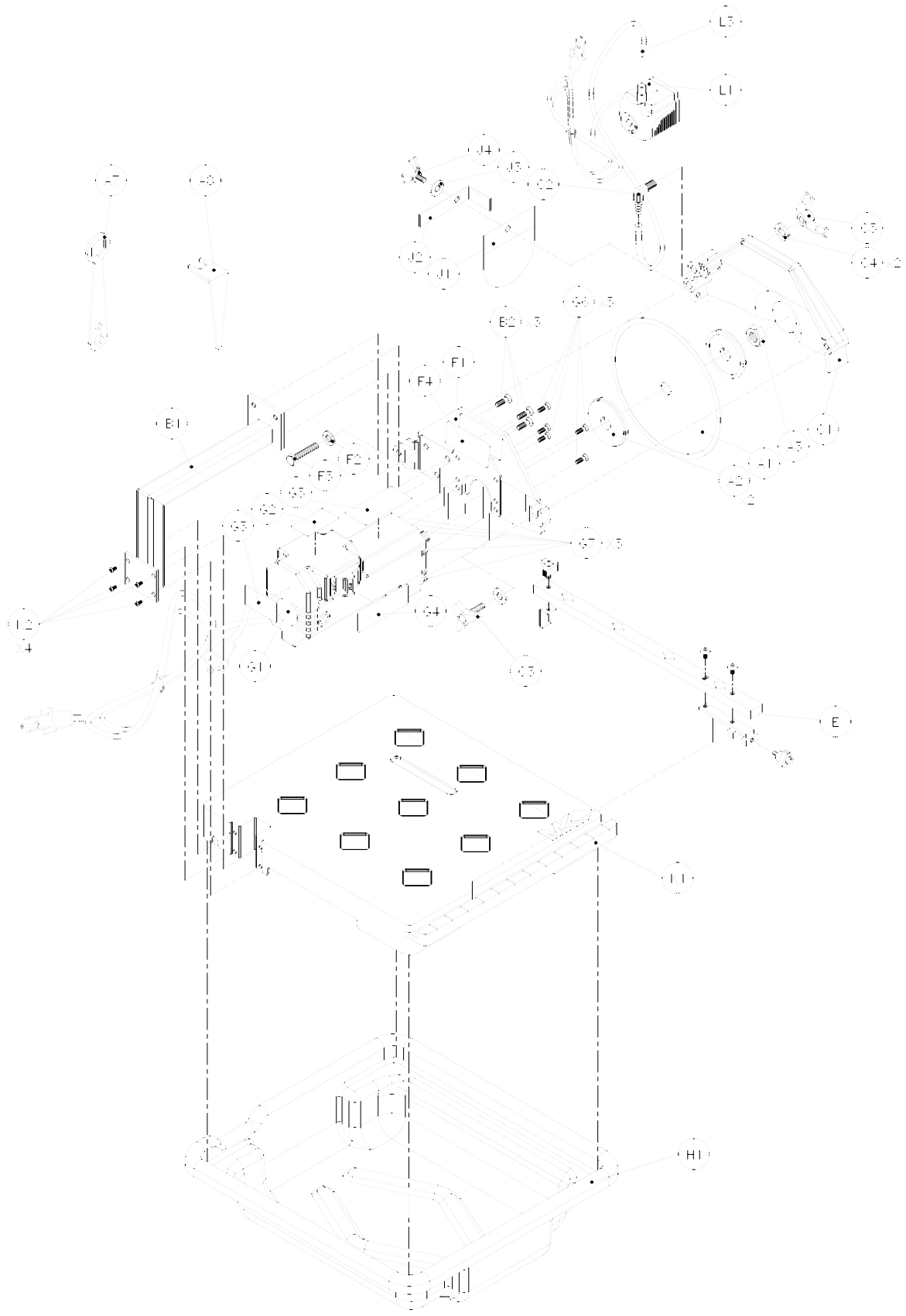

Item	Description	Qty	Part #
A	Accessories, 170	--	--
A1	Blade, 7 Dia x 5/8 Arbor MK-170	1	153441
A2	Flange, Blade	2	135830
A3	Nut, 5/8-18 UNF	1	135848
A4	Owner's Manual, 170	1	157243
A7	Wrench, Blade Nut, 15/16 Boxed End	1	134684
A8	Wrench, Blade Shaft, 11/16 Open End, 90°	1	157244
B	Arm, Motor Support	--	--
B1	Arm, Motor Support	1	157245
B2	Screw, 1/4-20 x 1/2 Flat Head Phillips Cap	3	155812
C	Assembly, Blade Guard, 7"	1	154811-MK
C1	Guard, 7" Blade	1	154811
C2	Elbow, 1/8 MNPT x 1/4 BARB 90° Brass	1	154652
C3	Knob, Davies	1	151681
C4	Washer, 5/16 SAE Flat	2	151754
C5	Wing nut, 5/16-18 Nylock	1	151746
E	Assembly, Fence, 170	1	157406
E1	Fence, Upper	1	157247
E2	Fence, Lower	1	157248
E3	Screw, 10-24 x 3/8 Pan Head Phillips Machine	2	151097
E4	Knob, 1/4-20 x 3/4 Three Prong	1	157583-2
E5	Knob, 10-32 x 1/2 Three Prong	1	157583-1
E6	Clip, Fence	1	157559
F	Motor Mount	--	--
F1	Motor Mount	1	157403
F2	Washer, 5/16 Split Lock	1	151747
F3	Screw, 5/16-18 x 2 1/2 Hex Head Cap, Full Thread	1	151748
F4	Tag, Serial Number, UL Mark	1	157249-02
G	Motor, 120v/4.7a, 170	--	--
G1	Motor, 120v/4.7a, 170	1	157226-G
G2	Label, Caution, GFCI, 1 x 2 1/8	1	155678
G3	Label, Caution, Receptacle, 1 x 2 1/8	1	154822
G4	Label, Motor, 170	1	157251
G5	Label, Warning, Read Owner's Manual	1	155806
G6	Screw, M5-.8 x 20mm Flat Head Phillips Machine	5	157404
G7	Nut, M5-.8 Hex	5	157405
H	Pan, Water, 170	--	--
H1	Pan, Water, 170	1	157252
J	Splash Curtain	--	--
J1	Curtain, Splash	1	134841
J2	Bracket, Splash Curtain	1	155901
J3	Washer, 1/4 SAE Flat	1	151915
J4	Wing-screw, 1/4-20 x 1/2	1	151888

Item	Description	Qty	Part #
K	Table, 170	--	--
K1	Table, 170	1	157253
K2	Screw, 10-24 x 1/2 Pan Head Phillips Machine	4	151744
L	Water Pump, PES-100 120v	--	--
L1	Pump, Water, PES-100 120v	1	155987
L3	Hose, Vinyl, 1/4 ID	34"	132951
L4	Owner's Manual, Water Pump	1	155745

THEORY OF DIAMOND BLADES

Diamond blades do not really cut; they grind the material through friction. Diamond crystals, often visible at the leading edge and sides of the rim/segment, remove material by scratching out particles of hard, dense materials, or by knocking out larger particles of loosely bonded abrasive material. This process eventually cracks or fractures the diamond particle, breaking it down into smaller pieces. As a result, a diamond blade for cutting soft, abrasive material must have a hard metal matrix composition to resist this erosion long enough for the exposed diamonds to be properly utilized. Conversely, a blade for cutting a hard, non-abrasive material must have a soft bond to ensure that it will erode and expose the diamonds embedded in the matrix. These simple principles are the foundation of “controlled bond erosion.”



TYPES OF CUTTING

There are two basic types of cutting-Dry or Wet. The choice of which type of blade to use depends on:

- The requirements of the job
- The machine/tool utilizing the diamond blade
- The preference of the operator

In the case of DRY cutting, the overwhelming popularity and quantity of hand-held saws and the flexible nature of MK Diamond blades to professionally handle most ceramic, masonry, stone and concrete materials, make the DRY cutting blade a very attractive tool. When using a DRY blade, the user must be aware of distinct operating practices to ensure optimum performance. DRY cutting blades require sufficient airflow about the blade to prevent overheating of the steel core. This is best accomplished by shallow, intermittent cuts of the material with periods of “free-spinning” (for several seconds) between each cut, to maximize the cooling process.

For WET cutting applications, MK has the exact blade to compliment both the material to be cut and the wet cutting machine to be used. During cutting operations, liberal amounts of water act as a coolant to support the cutting effectiveness and longevity of the WET blade. Additionally, using water adds to the overall safety of cutting operations by keeping the dust signature down.

Know All You Can About the Material You Wish to Cut

ORDERING INFORMATION

You may order MK Diamond products through your local MK Diamond distributor or, you may order direct from MK Diamond.

When ordering direct from MK Diamond, please have the following information ready before calling:

- The Model Number of the saw
- The Serial Number of the saw
- Where the saw was purchased and when
- The Part Number for the part(s) being ordered
- The Part Description for the part(s) being ordered

NOTE: There is a \$25.00 minimum order when ordering direct from MK Diamond. A \$6.00 charge will be added to orders having a net billing value under \$50.00. All purchases must be made using VISA, MasterCard or American Express.

All parts may be ordered by calling toll free to – 800 421-5830 or 310 539-5221 and asking for Customer Service. For technical questions, call – 800 474-5594.

RETURN MATERIALS POLICY

To expedite the service relative to the return of a product purchased through MK Diamond, please observe the following:

NOTE: When returning all items, they must have been purchased within the previous twelve (12) months.

- Have the Model Number of the saw
- Have the Serial Number of the saw
- Have the location of where the saw was purchased
- Have the date when the saw was purchased
- Contact Customer Service for approval to return the item(s)
- Obtain a Returned Goods Number (RGA) authorizing the return
- Follow the packaging instructions in the following section
- Ensure your item(s) are prepaid to the destination

For returned items, call toll free to – 800 421-5830 or 310 539-5221 and ask for Customer Service. For technical questions, call – 800 474-5594 or 310 257-2845.

PACKAGING INSTRUCTIONS

- Remove the Cutting Head and Support Angle Assembly
- Dry the saw before shipping
- When packing, include the following: Saw, Diamond Blade, Blade Guard and Support Angle Assembly and Adjustable Cutting Guide (Other Accessories are not required)
- Package the unit in its original container or one of comparable size (do not ship the unit partially exposed)
- Ensure all parts are secured in the packaging to prevent moving

AUTHORIZED SERVICE CENTERS

For quicker repair time, you may contact MK Diamond Customer Service, toll free, at 800 421-5830 or 310 539-5221 for the Authorized Service Center closest to you or visit our web site at www.mkdiamond.com. For technical questions, call – 800 474-5594.

CONTACT

Please contact MK Diamond Products, Inc. Customer Service Department with any questions you might have regarding distributors, parts or service.

Telephone: **(800) 421-5830**

Fax: **(310) 539-5158**

E-mail: **Customer_Service@MKDiamond.com**

Customer Service Hours: **Monday through Friday, 6AM-4PM PST**

**MK Diamond Products, Inc.
1315 Storm Parkway
Torrance, CA 90501**

MK DIAMOND PRODUCTS, INC. LIMITED WARRANTY

MK DIAMOND PRODUCTS, INC. will guarantee every machine they build, to be free from defects in material and workmanship for (1) one year from date of purchase. The obligation of MK DIAMOND PRODUCTS, INC. under this warranty is limited to the repair or replacement of any parts which, under normal use, prove to be defective in material or workmanship. The parts involved or the unit in question should be returned to MK DIAMOND PRODUCTS, INC. or to a point designated by us, transportation prepaid.

This warranty does not obligate us to bear the cost of labor or transportation charges in connection with replacement or repair of defective parts. Likewise, it shall NOT apply to any unit which has been subjected to misuse, neglect or accident. This warranty does NOT apply to any machine which has been repaired or altered outside our factory.

This warranty does NOT obligate MK DIAMOND PRODUCTS, INC., with respect to items not of our manufacture, such as engines, motors, hydraulics, etc., which are subject to their own guarantees and warranties.

We shall in no event be liable for consequential damages or contingent liabilities arising out of failure of any equipment or parts to operate properly.

© COPYRIGHT 2015, MK DIAMOND PRODUCTS, INC. ALL RIGHTS RESERVED.

The MK Diamond logo is a registered trademark of MK Diamond Products, Inc. and may not be used, reproduced, or altered without written permission. All other trademarks are the property of their respective owners and used with permission.

MK Diamond may have patents, patent applications, trade marks, copyrights of other intellectual property right covering this product in this document.

This manual MUST accompany the equipment at all times. This manual is considered a permanent part of the equipment and should remain with the unit if resold.

The information and specifications included in this publication were in effect at the time of approval for printing.

MK-170 TILE SAW
OWNER'S MANUAL & OPERATING INSTRUCTIONS



MK Diamond Products, Inc.

MK Diamond Products, Inc.
1315 Storm Parkway
Torrance, CA 90501

Toll-Free: (800) 421-5830
Phone: (310) 539-5221
Fax: (310) 539-5158
www.mkdiamond.com