



# SERVICE PARTS LIST

**BULLETIN NO.**  
**54-07-2220**

SPECIFY CATALOG NO. AND SERIAL NO. WHEN ORDERING PARTS		REVISED BULLETIN	DATE
<b>CLAMP METER (HVAC Clamp)</b>			June 2009
<b>CATALOG NO.</b>	<b>2236-20</b>	<b>SERIAL NUMBER</b>	<b>B86A</b>
WIRING INSTRUCTION			

**EXAMPLE:**  

00	0
----	---

 Component Parts (Small #) Are Included  
 When Ordering The Assembly (Large #).

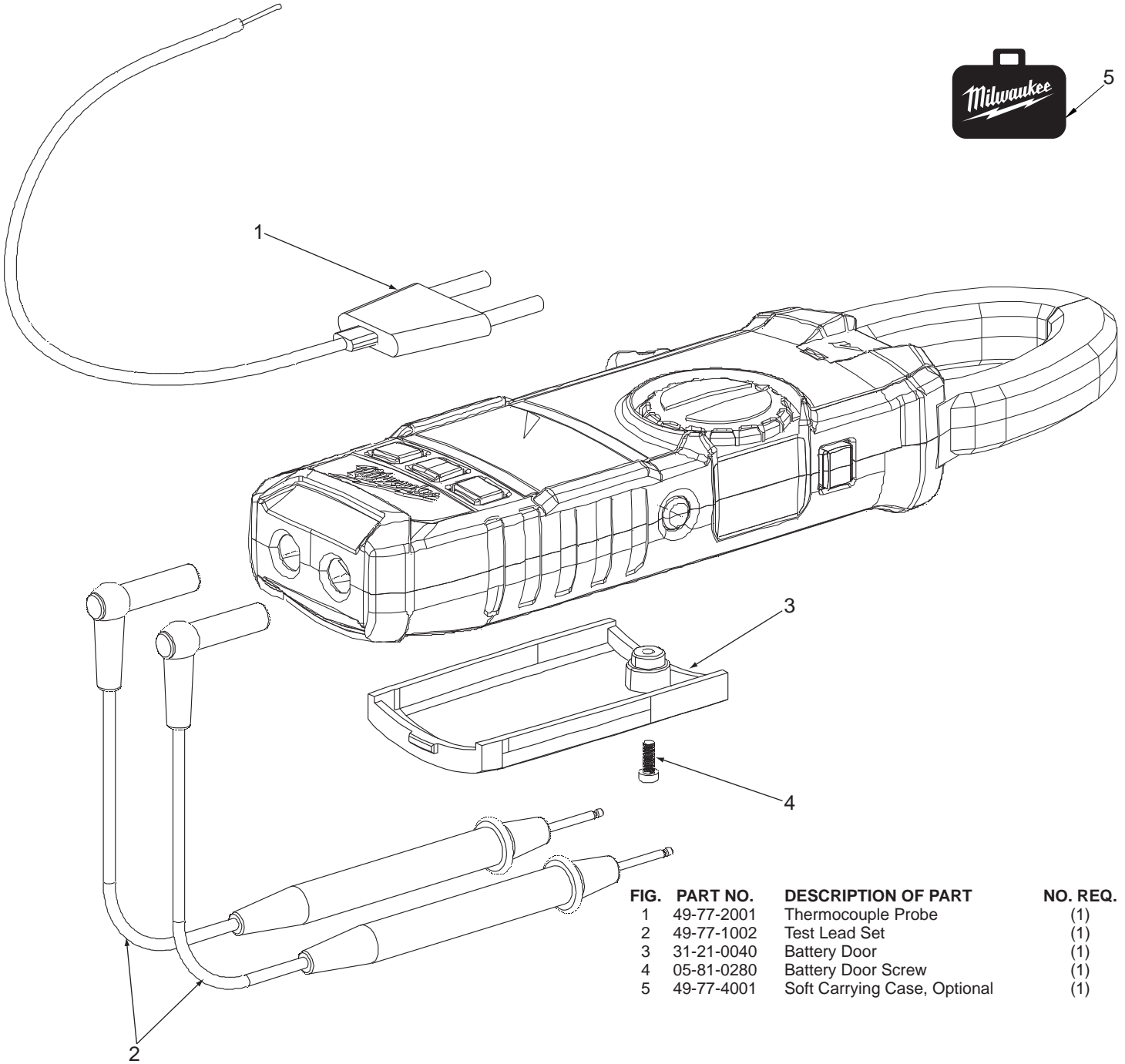

FIG.	PART NO.	DESCRIPTION OF PART	NO. REQ.
1	49-77-2001	Thermocouple Probe	(1)
2	49-77-1002	Test Lead Set	(1)
3	31-21-0040	Battery Door	(1)
4	05-81-0280	Battery Door Screw	(1)
5	49-77-4001	Soft Carrying Case, Optional	(1)