

# WORX®

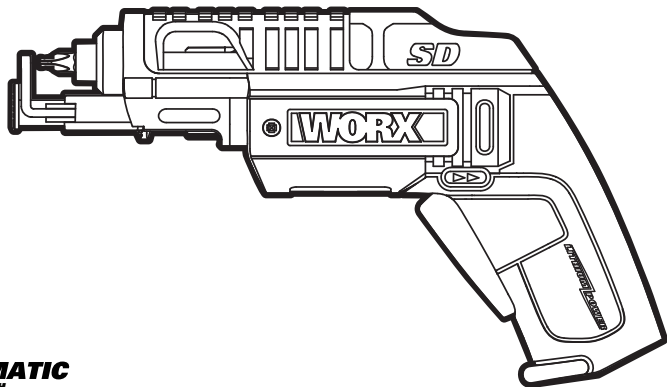

**SD**  
**SEMIAUTOMATIC**  
**DRIVER™ WITH**  
**SCREW HOLDER**



HELPLINE NUMBER  
NUMÉRO DU SERVICE D'ASSISTANCE  
NÚMERO DE LÍNEA DE AYUDA  
1-866-354-WORX (9679)

**WX255L**

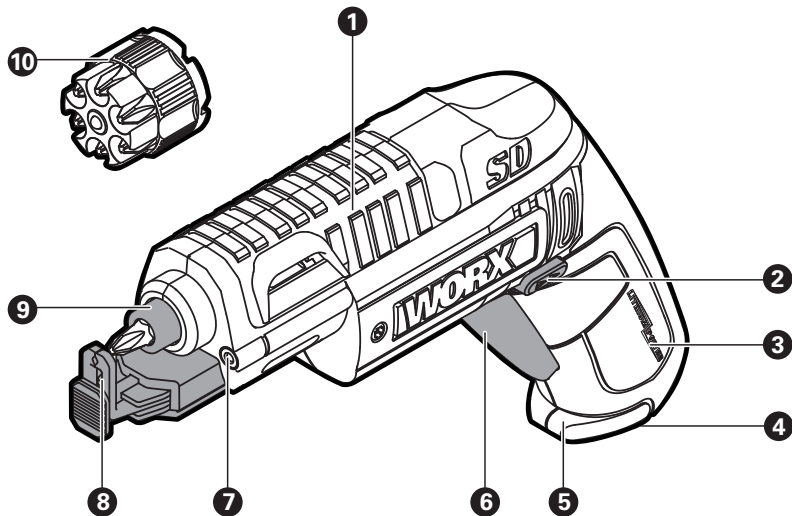

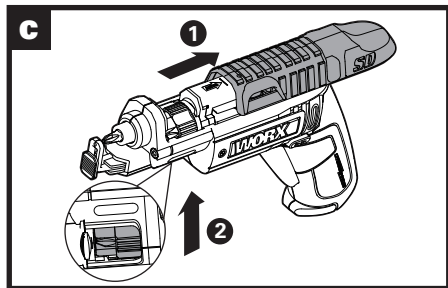
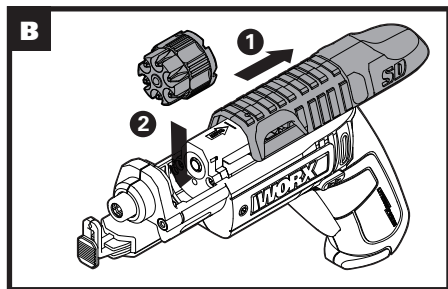
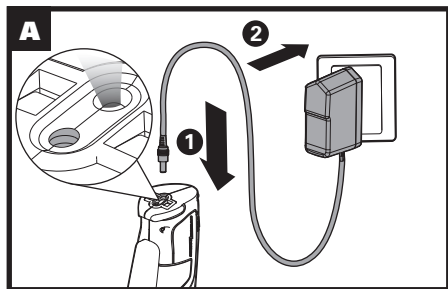

**D1**

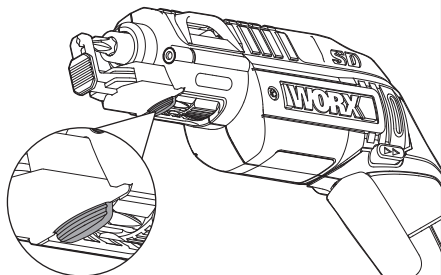
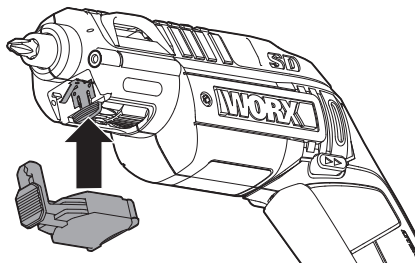

**D2**

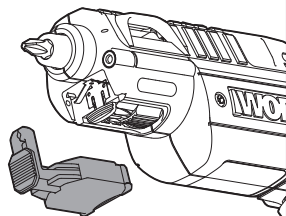
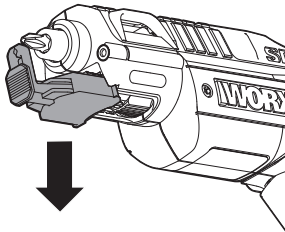
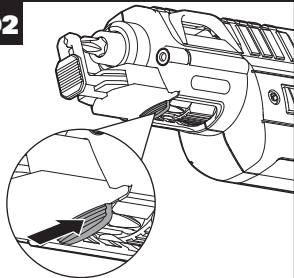



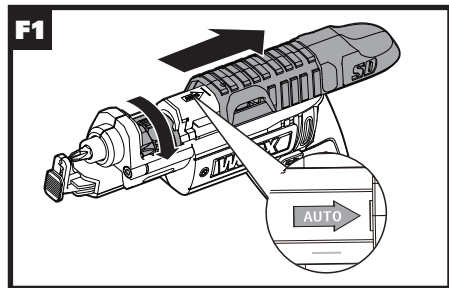
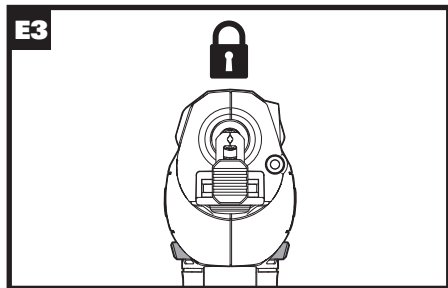
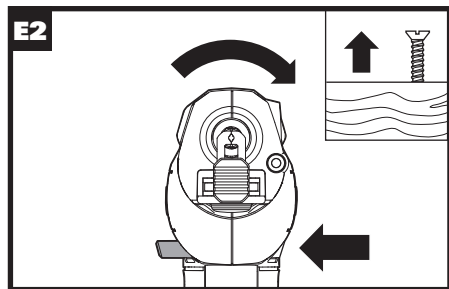
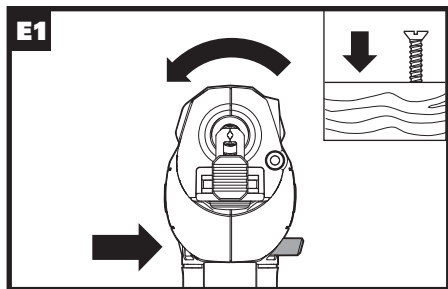

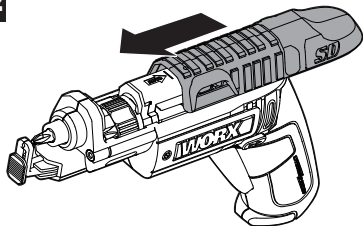
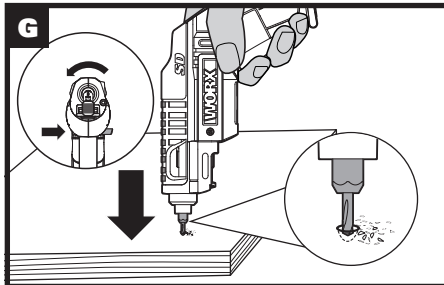
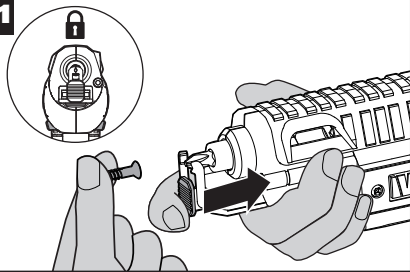
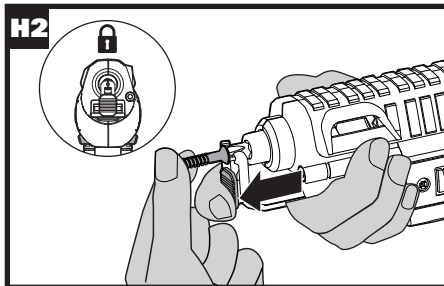

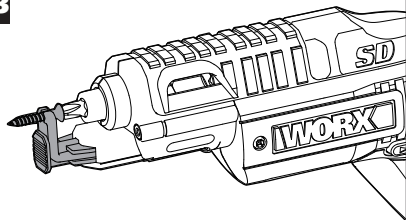
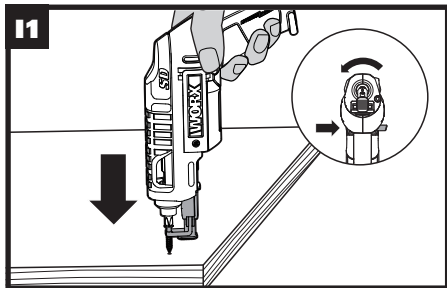
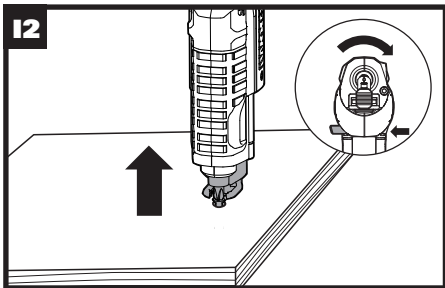
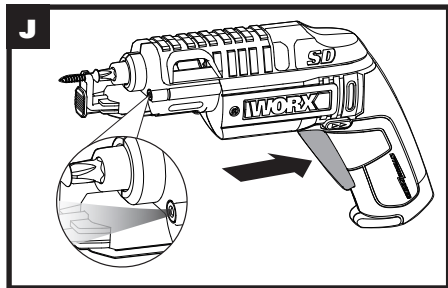
**F2****G****H1****H2**

**H3****I1****I2****J**

- 
- |  |
|--|
| <b>1. SLIDE COVER</b>                      |
| <b>2. FORWARD/REVERSE ROTATION CONTROL</b> |
| <b>3. SOFT GRIP HANDLE</b>                 |
| <b>4. CHARGING INDICATOR</b>               |
| <b>5. CHARGING SOCKET</b>                  |
| <b>6. ON/OFF SWITCH</b>                    |
| <b>7. LED LIGHT</b>                        |
| <b>8. SCREW HOLDER</b>                     |
| <b>9. CHUCK</b>                            |
| <b>10. BIT CARTRIDGE</b>                   |
- 

**Not all the accessories illustrated or described are included in standard delivery.**

## TECHNICAL DATA

Charger input	100-240V~ 50/60Hz 190mA
Charger output	4.2V 500mA
Rated voltage	4V  Max*
Charger input power	3W
Battery capacity	1.5Ah
Battery type	lion
Battery model no.	ISR18650
No-load speed	230/min
Maximum torque	27 in.lbs
Machine weight	1.1 lbs
Charger protection class	 /II
Charging time	5 hours (Approx.)

\* Voltage measured without workload. Initial battery voltage reaches maximum of 4 volts. Nominal voltage is 3.6 volts.

## ACCESSORIES

**Screwdriver bit (PH1, PH2, SL4, SL6, SQ1, SQ2)**

**Cartridge**

**Charger**

**6**

**1**

**1**

We recommend that you purchase your accessories from the same store that sold you the tool. Use good quality accessories marked with a well-known brand name. Choose the type according to the work you intend to undertake. Refer to the accessory packaging for further details. Store personnel can assist you and offer advice.

 **WARNING:** Some dust created by power sanding, sawing, grinding, drilling and other construction activities contains chemicals known to the State of California to cause cancer, birth defects or other reproductive harm. Some examples of these chemicals are:

- Lead from lead-based paints;
- Crystalline silica from bricks and cement and other masonry products and
- Arsenic and chromium from chemically-treated lumber.

Your risk from these exposures varies, depending on how often you do this type of work. To reduce your exposure to these chemicals:

- Work in a well ventilated area, and
- Work with approved safety equipment, such as those dust masks that are specially designed to filter out microscopic particles.

 **WARNING:** This product may contain lead, phthalate or other chemicals known to the State of California to cause cancer, birth defects and other reproductive harm. Please wash your hands after use.

## **GENERAL POWER TOOL SAFETY WARNINGS**

 **WARNING: Read all safety warnings and instructions.** Failure to follow the warnings and instructions may result in electric shock, fire and/or serious injury.

**Save all warnings and instructions for future reference.**

The term power tool in the warnings refers to your mains-operated (corded) power tool or battery-operated (cordless) power tool.

### **1) WORK AREA SAFETY**

- a) Keep work area clean and well lit.** Cluttered or dark areas invite accidents.
- b) Do not operate power tools in explosive atmospheres, such as in the presence of flammable liquids, gases or dust.** Power tools create sparks which may ignite the dust or fumes.
- c) Keep children and bystanders away while operating a power tool.** Distractions can cause you to lose control.

### **2) ELECTRICAL SAFETY**

- a) Power tool plugs must match the outlet. Never modify the plug in any way. Do not use any adapter plugs with grounded power tools.** Unmodified plugs and matching outlets will reduce risk of electric shock.
- b) Avoid body contact with grounded surfaces such as pipes, radiators, ranges and refrigerators.** There is an increased risk of electric shock if your body is earthed or grounded.
- c) Do not expose power tools to rain or wet conditions.** Water entering a power tool will increase the risk of electric shock.
- d) Do not abuse the cord. Never use the cord for carrying, pulling or unplugging the power tool. Keep cord away from heat, oil, sharp edges or moving parts.**

Damaged or entangled cords increase the risk of electric shock.

- e) **When operating a power tool outdoors, use an extension cord suitable for outdoor use marked "W-A" or "W".** Use of a cord suitable for outdoor use reduces the risk of electric shock.
- f) **If operating a power tool in a damp location is unavoidable, use a Ground Fault Circuit Interrupter (GFCI) protected supply.** Use of a GFCI reduces the risk of electric shock.

### 3) PERSONAL SAFETY

- a) **Stay alert, watch what you are doing and use common sense when operating a power tool. Do not use a power tool while you are tired or under the influence of drugs, alcohol or medication.** A moment of inattention while operating power tools may result in serious personal injury.
- b) **Use personal protective equipment. Always wear eye protection.** Protective equipment such as dust mask, non-skid safety shoes, hard hat, or hearing protection used for appropriate conditions will reduce personal injuries.
- c) **Prevent unintentional starting. Ensure the switch is in the off-position before connecting to power source and/or battery pack, picking up or carrying the tool.** Carrying power tools with your finger on the switch or energizing power tools that have the switch on invites accidents.

- d) **Remove any adjusting key or wrench before turning the power tool on.** A wrench or a key left attached to a rotating part of the power tool may result in personal injury.
- e) **Do not overreach. Keep proper footing and balance at all times.** This enables better control of the power tool in unexpected situations.
- f) **Dress properly. Do not wear loose clothing or jewelry. Keep your hair, clothing and gloves away from moving parts.** Loose clothes, jewelry or long hair can be caught in moving parts.
- g) **If devices are provided for the connection of dust extraction and collection facilities, ensure these are connected and properly used.** Use of dust collection can reduce dust-related hazards.

### 4) POWER TOOL USE AND CARE

- a) **Do not force the power tool. Use the correct power tool for your application.** The correct power tool will do the job better and safer at the rate for which it was designed.
- b) **Do not use the power tool if the switch does not turn it on and off.** Any power tool that cannot be controlled with the switch is dangerous and must be repaired.
- c) **Disconnect the plug from the power source and/or the battery pack from the power tool before making any adjustments, changing accessories, or storing power tools.** Such preventive safety

measures reduce the risk of starting the power tool accidentally.

- d) **Store idle power tools out of the reach of children and do not allow persons unfamiliar with the power tool or these instructions to operate the power tool.** Power tools are dangerous in the hands of untrained users.
- e) **Maintain power tools. Check for misalignment or binding of moving parts, breakage of parts and any other condition that may affect the power tools operation. If damaged, have the power tool repaired before use.** Many accidents are caused by poorly maintained power tools.
- f) **Keep cutting tools sharp and clean.** Properly maintained cutting tools with sharp cutting edges are less likely to bind and are easier to control.
- g) **Use the power tool, accessories and tool bits etc., in accordance with these instructions and in the manner intended for the particular type of power tool, taking into account the working conditions and the work to be performed.** Use of the power tool for operations different from those intended could result in a hazardous situation.
- h) **Use clamps or another practical way to secure and support the workpiece to a stable platform.**
- i) **Holding the work by hand or against your**

**body leaves it unstable and may lead to loss of control.**

## **5) BATTERY TOOL USE AND CARE**

- a) **Recharge only with the charger specified by the manufacturer.** A charger that is suitable for one type of battery pack may create a risk of fire when used with another battery pack.
  - b) **Use power tools only with specifically designated battery packs.** Use of any other battery packs may create a risk of injury and fire.
  - c) **When battery pack is not in use, keep it away from other metal objects, like paper clips, coins, keys, nails, screws or other small metal objects, that can make a connection from one terminal to another.** Shorting the battery terminals together may cause burns or a fire.
  - d) **Under abusive conditions, liquid may be ejected from the battery; avoid contact. If contact accidentally occurs, flush with water. If liquid contacts eyes, additionally seek medical help.** Liquid ejected from the battery may cause irritation or burns.
- ## **6) SERVICE**
- a) **Have your power tool serviced by a qualified repair person using only identical replacement parts.** This will ensure that the safety of the power tool is maintained.



## SCREWDRIVER SAFETY WARNINGS

- 1. Hold power tool by insulated gripping surfaces, when performing an operation where the fastener may contact hidden wiring.** Fasteners contacting a “live” wire may make exposed metal parts of the power tool “live” and could give the operator an electric shock.

## GENERAL SAFETY WARNINGS FOR YOUR BATTERY CHARGER

 **WARNING:** This product maybe contains lead, phthalate or other chemicals known to the State of California to cause cancer, birth defects and other reproductive harm. Please wash your hands after use.

This device complies with Canadian ICES-001.  
This device complies with Part 15 of the FCC Rules.  
Operation is subject to the following two conditions:  
(1) this device may not cause harmful interference, and  
(2) this device must accept any interference received, including interference that may cause undesired operation.

 **WARNING:** Changes or modifications to this unit not expressly approved by the party responsible for compliance could void the user's authority to operate the equipment.

**NOTE:** This equipment has been tested and found to comply with the limits for a Class B digital device, pursuant to Part 15 of the FCC Rules.

These limits are designed to provide reasonable protection against harmful interference in a residential installation. This equipment generates, uses and can radiate radio frequency energy and, if not installed and used in accordance with the instructions, may cause harmful interference to radio communications. However, there is no guarantee that interference will not occur in a particular installation. If this equipment does cause harmful interference to radio or television reception, which can be determined by turning the equipment off and on, the user is encouraged to try to correct the interference by one or more of the following measures:

- Reorient or relocate the receiving antenna.
- Increase the separation between the equipment and receiver.
- Connect the equipment into an outlet on a circuit different from that to which the receiver is connected.
- Consult the dealer or an experienced radio/TV technician for help.







## SAFETY INSTRUCTIONS FOR BATTERY

- 1) WARNING: Risk of fire and burns. Do not disassemble, heat above 100°C (212°F), or incinerate. Do not expose cells or batteries to heat or fire. Avoid storage in direct sunlight.**
- 2) Dispose of used battery promptly.. When disposing of secondary cells or batteries,**

- keep cells or batteries of different electrochemical systems separate from each other.
- 3) **Keep battery out of reach of children and in original package until ready to use.**
  - 4) **Never put batteries in mouth. If swallowed, contact your physician or local poison control center.**
  - 5) **CAUTION – The battery used in this device may present a risk of fire or chemical burn if mistreated. Replace battery with ( WORX ) only. Use of another battery may present a risk of fire or explosion**
  - 6) **Warning: Do not use a visibly damaged battery pack or appliance as applicable.**
  - 7) **Warning: Do not modify or attempt to repair the appliance or the battery pack as applicable.**
  - 8) **BATTERY MUST BE RECYCLED**
  - 9) **Do not short-circuit a cell or battery. Do not store cells or batteries haphazardly in a box or drawer where they may short-circuit each other or be short-circuited by conductive materials.**
  - 10) **Do not subject cells or batteries to mechanical shock.**
  - 11) **Keep cells and batteries clean and dry. Wipe the cell or battery terminals with a clean dry cloth if they become dirty.**
  - 12) **Do not maintain secondary cells and batteries on charge when not in use.**
  - 13) **Retain the original cell and battery literature for future reference.**
  - 14) **Do not use any charger other than that specifically provided for use with the equipment. Secondary cells and batteries need to be charged before use.** Always use the correct charger and refer to the manufacturer's instructions or equipment manual for proper charging instructions.
  - 15) When possible, remove the battery from the equipment when not in use.
  - 16) Prevent unintentional starting. Ensure the switch is in the off-position before connecting to battery pack, picking up or carrying the appliance. Carrying the appliance with your finger on the switch or energizing appliance that have the switch on invites accidents.

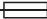
## SYMBOL

	<b>Do not stare directly into the tool holder.</b> When changing the tool insert, it can be thrown out toward the front.
	To reduce the risk of injury, user must read instruction manual
	Warning
	Double insulation
	Wear eye protection
	Wear ear protection
	Wear dust mask
	Do not burn
	Do not expose to rain or water



	Wear protective gloves
	Do not dispose of batteries, Return exhausted batteries to your local collection or recycling point.
	For indoor use only
	Fuse T 1A time lag fuse with rated current of 1A
	The output plug is with positive center pole and negative outer pole
	Don't use double end bit
	POSITEC Inc. has established a partnership with the RBRC Corporation to recycle any Positec batteries with the RBRC-call2recycle seal. For environmental protection, please do not discard batteries in the trash. After the batteries' life cycle is ended, then please call 1-800-822-8837 for a free service that will properly dispose of the battery.

call2recycle

## OPERATING INSTRUCTIONS



**NOTE:** Before using the tool, read the instruction book carefully.

ACTION	FIGURE
<b>BEFORE OPERATION</b>	
Charging the Battery <b>NOTE:</b> 1. Maximize Battery Performance Prior to initial use, the battery must be charged 5 hours to fully utilize the battery capacity. 2. When the battery is full charged, the light turns green.	See Fig. A
<b>ASSEMBLY AND ADJUSTMENT</b>	
<b>Inserting and Removing the Bit Cartridge</b>	See Fig. B,C
<b>Assembling and Removing the Screw Holder</b>	See Fig. D1,D2
Forward/Reverse/Lock  <b>WARNING:</b> Never change the direction of rotation when the chuck is rotating, wait until it is stopped!	See Fig. E1,E2,E3
<b>OPERATION</b>	
Selecting a Bit	See Fig. F1, F2
Drilling a Pilot Hole	See Fig. G
Assembling screw	See Fig. H1, H2, H3
Tightening and Loosening Screw	See Fig. I1, I2
Operating the On/Off Switch  <b>WARNING:</b> Do not operate for long periods at low speed because excess heat will be produced internally.	See Fig. J
LED Light Indicator	See Fig. J
Automatic Spindle Locking <b>NOTE:</b> When the slide driver is out of power, this function enables the customer tightening or loosening screws manually.	



**[www.worx.com](http://www.worx.com)**

Copyright © 2015, Positec. All Rights Reserved.

Copyright © 2015, Positec. Tous droits réservés.

Derechos reservados © 2015, Positec. Todos los derechos reservados.

2CSD24APK11003A0