

## Spare parts list

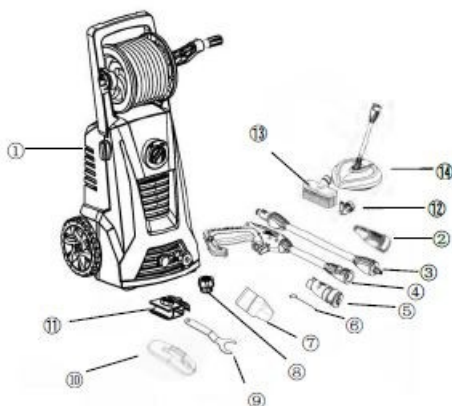

1. Machine
2. Turbo Nozzle
3. Gun Lance
4. Spray Gun Body
5. Normal Nozzle
6. Cleaning Pin
7. Detergent Nozzle
8. Garden Water Inlet Connector
9. Wrench
10. Cable tractor
11. Gun holder
12. Angle Nozzle
13. Car brush
14. Patio cleaner

## 2. First time instructions

This section will explain in detail how to prepare this Electric Pressure Washer for first time use.

### SAFETY DEVICES

- The unload valve can reduce pressure if it exceeds pre-set values.

Locking device on trigger gun (see illustration at the beginning of this manual): The trigger gun features a locking device. When the knob is activated, the trigger gun cannot be operated.

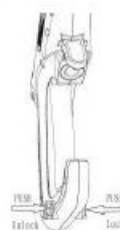

### THERMAL SENSOR

A thermal sensor protects the motor against overloading. The machine will restart after a few minutes when the thermal sensor has cooled.

## 3. Operation instructions

### 3.1 Connection of garden hose

Screw the water inlet coupling (3) tight on to the water inlet. Note: The inlet filter (A) must always be fitted in the water inlet pipe to filter out sand, lime stone and other impurities as these will damage the pump valves.

Caution: Failure to fit the filter will invalidate the guarantee.

Connect the garden hose with a standard garden connector (18).

