

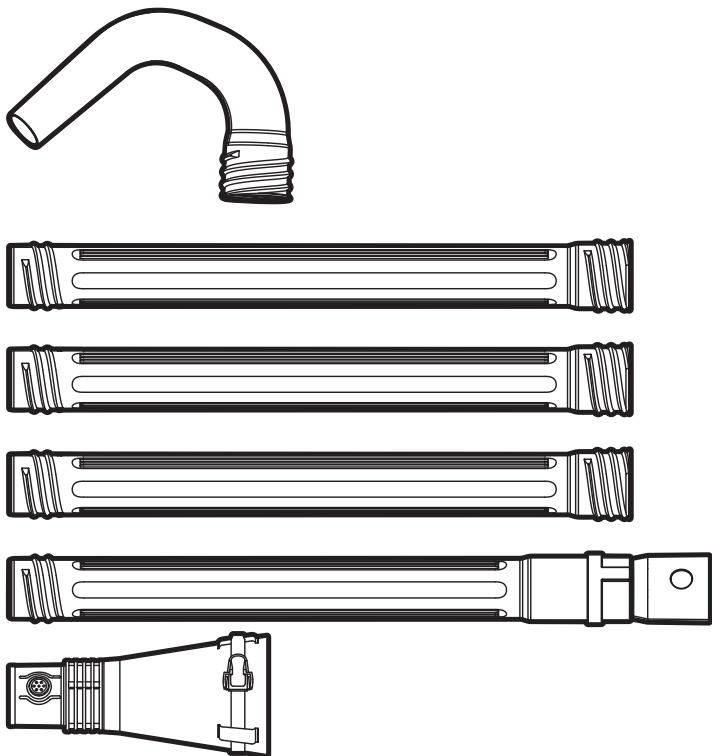

WORX



GUTTERPRO Universal Gutter Cleaning Kit	EN	P06
Trousse de nettoyage de gouttières GUTTERPRO	F	P07
Kit de limpieza de canales GUTTERPRO	ES	P09



HELPLINE NUMBER
1-866-354-WORX (9679)

WA4092

Fits all brands of blower/vacs up to 5" in diameter

s'adapte à toutes les marques de souffleurs aspirateurs de 5" de diamètre

Sirve para todo tipo de extractores/aspiradoras de hasta de 5" de diámetro (12,7 cm)

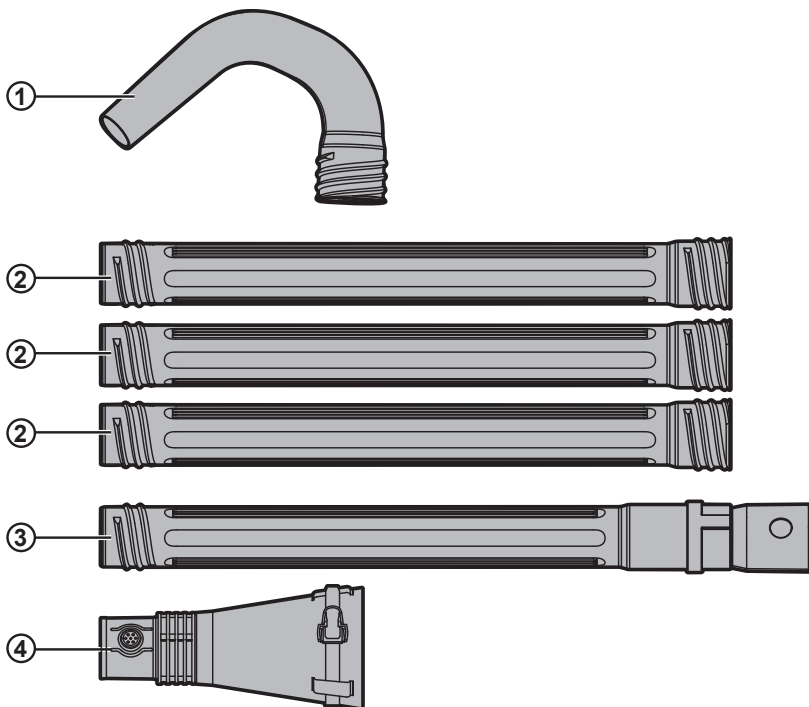

1. GUTTER TUBE NOZZLE (QUANTITY OF 1)

2. GUTTER TUBE EXTENSION (QUANTITY OF 3)

3. GUTTER TUBE ADAPTER (QUANTITY OF 1)

4. UNIVERSAL ADAPTOR

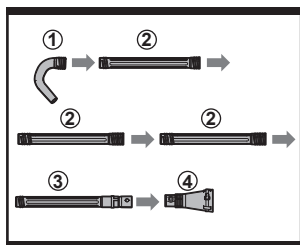

A1

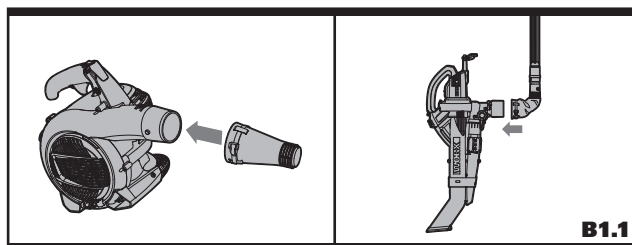

B1

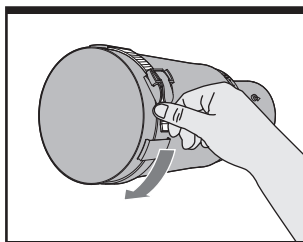

B2

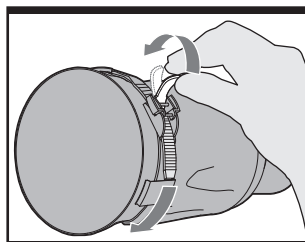

B3

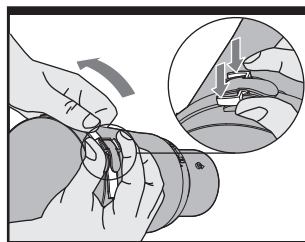

B4

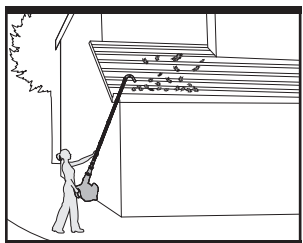

C

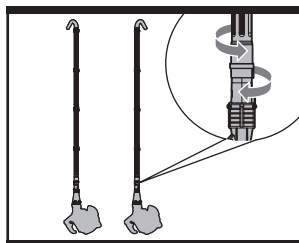

D

SAFETY INSTRUCTIONS



WARNING! User must read the product manual to fully understand this product prior to use, and follow all safety instructions as outlined in the WORXAIR™ Operator's Manual.



CAUTION! The user must wear the appropriate clothing and safety goggles when operating this product. Be aware of all bystanders, pets and objects in a close proximity.

- **DO NOT** operate blower and attachments when fatigued.
- **DO NOT** overreach or stand on unstable support. Keep good footing and balance at all times.
- Never direct airflow towards bystanders. Always be aware of the direction that the debris will be thrown.
- Use a face filter mask to avoid breathing dust and debris.

WARNING: This product maybe contains lead, phthalate or other chemicals known to the State of California to cause cancer, birth defects and other reproductive harm. Please wash your hands after use.

ASSEMBLY AND OPERATION

1. ATTACH THE GUTTER KIT AS SHOWN IN Fig. A1:

Connect the (1, 2, 3) components by screwing together. Snap the (3, 4) components together.

2. ASSEMBLING THE UNIVERSAL ADAPTOR

(1) Place the fabric side of the Universal Adapter over the Blower Outlet and slide it on as far as possible (B1).

(a) WORXTRIVAC models - Place the fabric side of the Universal Adapter over the Vacuum Outlet and slide it on as far as possible (B1.1). Before operation, flip the blow/vac switch into the vacuum mode.

PLEASE NOTE: Items can be vacuumed through the vac inlet and pass through or ~~clog the gutter kit~~. Please keep the vac inlet away from objects while using the gutter kit.

- (2) Check to make sure the strap is threaded through the locking mechanism. Then pull to tighten the strap (B2). Increase the tension by pulling the latch up and down to tighten (B3). To loosen, simply press the two outside latches down and then pull the strap out from other side (B4).
- (3) Test that the Universal Adapter will not slide off of the blower outlet.
- (4) If further tightening is needed, then pull the middle latch up and down until the adapter is tight. Please recheck if it will slide off of the blower outlet. Realign and repeat these steps if needed (B3). To loosen, simply press the two outside latches down and then pull the strap out from other side (B4).

PLEASE NOTE: The Universal Adapter may have space between the Blower Outlet and Adapter Outlet after installation.

To remove the adapter, simply press the two outside latches down and loosen the strap to remove it from the Blower Outlet (B4).

NOTE:

Use only enough GutterTube Extensions to comfortably reach the inside of the gutter.

3. OPERATE ACCORDING TO Fig. C:

The GutterTube Nozzle can be adjusted to any desired direction by rotating the GutterTube Connector as shown in Fig. D. Gutter cleaning applications will vary. It is recommended to try various positions to find the most effective working position for the type of house and gutter design.



Designed in Italy. Made in China
Conçu en Italie. Fabriqué en Chine
Diseñado en Italia. Fabricado en China

Copyright © 2013, Positec. All Rights Reserved.
2CBV80APK11002A0